

CLUTCH & FLYWHEEL

Qty. Req'd.

1.	22A598	Clutch Face Plate	-----	1
2.	GCP101	Clutch Disc – Aftermarket	-----	1
2.	MM470	Clutch Disc – Hvy Duty – Solid Center	-----	1
2.	AHT596	Clutch Disc – Competition	-----	1
2.	GCP204	Clutch Disc – Solid Centre – O/E	-----	1
2.	MM285	Clutch Disc – 3 Pce. Kit (includes item 2, 15, 20)	-----	1
2.	GCP271	Clutch Disc – ‘82 to ‘90 – Verto	-----	1
2.	GCP90311	Clutch Disc – 1000cc – Verto	-----	1
2.	GCP90832	Clutch Disc – 1300cc – Verto	-----	1
2.	GCP90821	Clutch Disc – Turbo – Verto	-----	1
3.	12G3014	Flywheel Assembly	-----	1
3.	MM507	Flywheel Assembly – Lightened	-----	1
4.	12G676	Ringear	-----	1
8.	88G508	Key – Flywheel to Crankshaft	-----	1
9.	22A747	Bolt	-----	1
10.	22A1155	Locktab	-----	1
11.	2A3658	Driving Strap	-----	6
12.	2A3659	Bolt – Strap to Flywheel	-----	3
13.	2A3512	Locktab – OBSOLETE	-----	3
14.	GHF302	Washer – Plain	-----	3
15.	GCC102	Clutch Diaphragm Assembly – 998cc	-----	1
15.	GCC103	Clutch Diaphragm Assembly – 1300 & 1275 ‘S’	-----	1
15.	MM375	Clutch Diaphragm Assembly – Competition – Orange	-----	1
15.	MM429	Clutch Diaphragm Assembly – Race – Grey Spring	-----	1
16.	22G364	Clutch Bearing Release Plate – 998cc	-----	1
16.	22G1152	Clutch Bearing Release Plate – 1300cc	-----	1
17.	22A921	Circlip – Release Plate Retaining	-----	1
18.	2A3657	Bolt – Diaphragm	-----	3
19.	MM849	Lockwasher	-----	3
20.	GRB201	Clutch Release Bearing	-----	1
21.	MM795	Lightened Flywheel & Face Plate	-----	1

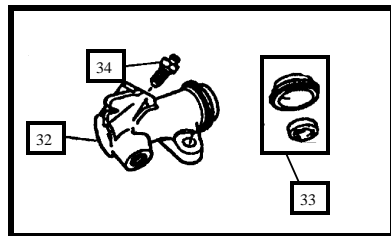
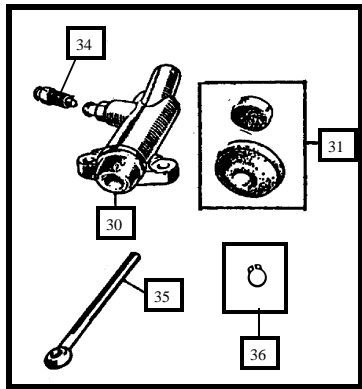
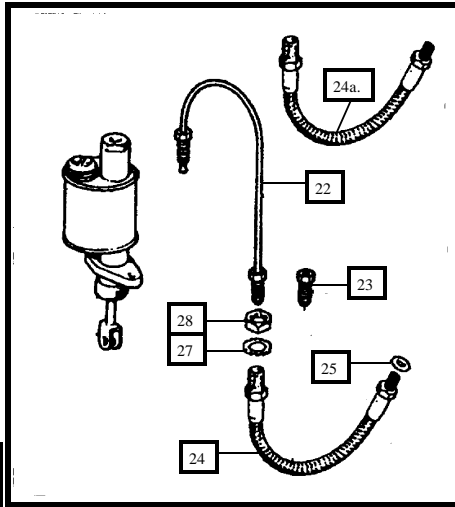
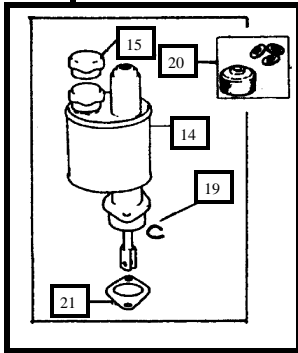
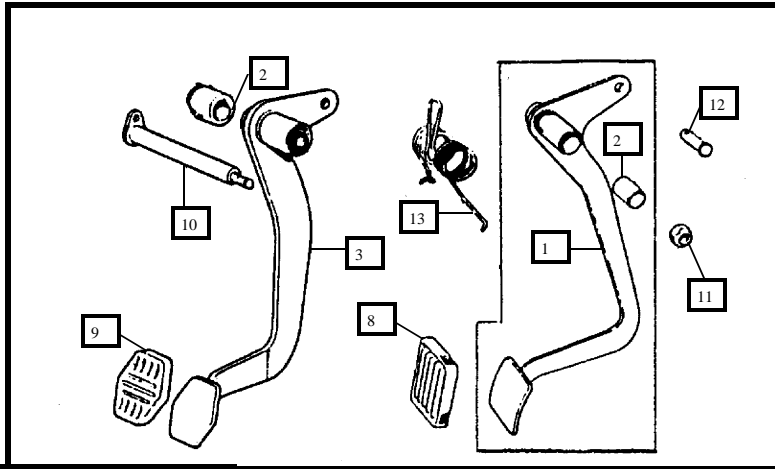

CLUTCH HYDRAULICS

		Qty. Req'd.
1.	2A5866	Pedal Assembly – to '77 (used only) -----1
2.	2A3034	Bush – Brass-----1
3.	FAM2010	Pedal Assembly – '77 on (used only) -----1
8.	GPR104	Pedal Pad – Rubber – to '77 -----1
9.	GPR107	Pedal Pad – Rubber – '77 on -----1
10.	2A5880	Shaft – Clutch & Brake Pedal -----1
11.	MM821	Locknut -----1
12.	CLZ512	Clevis Pin – Pedal to Master Cylinder-----1
13.	2A5652	Spring – Pedal Return -----1
14.	GMC1008	Clutch Master Cylinder-----1
15.	17H6861	Filler Cap – Plastic-----1
19.	17H7560	Circlip – Push Rod-----1
20.	8G8424	Clutch Master Cylinder Repair Kit – to '77 -----1
20.	BHM7127	Clutch Master Cylinder Repair Kit – '77 on-----1
21.	31G279	Gasket – Seating Master Cylinder-----1
22.	21A70	Pipe – Clutch Master Cyl. To Flexible Hose – 29” -----1
23.	MM511	Fitting – Male -----2
24.	13H300	Clutch Hose – Flexible-----1
24.	GVP1009	Clutch Hose – Verto -----1
24a.	MM538	Clutch Hose Kit – Braided-----1
25.	3H2287	Washer – Copper – Hose to Slave Cyl. -----1
27.	2K8686	Nut-----1
28.	LWZ510	Lockwasher -----1
30.	22A233	Clutch Slave Cylinder-----1
31.	8G8446	Clutch Slave Cylinder Repair Kit -----1
32.	MM007	Clutch Slave Cylinder – Aftermarket -----1
33.	MM631	Clutch Slave Cylinder Repair Kit – for MM007-----1
34.	3H2428	Bleed Screw-----1
35.	13H396	Push Rod-----1
36.	AAA81	Clutch Slave Circlip -----1

CLUTCH HOUSING

Qty. Req'd.

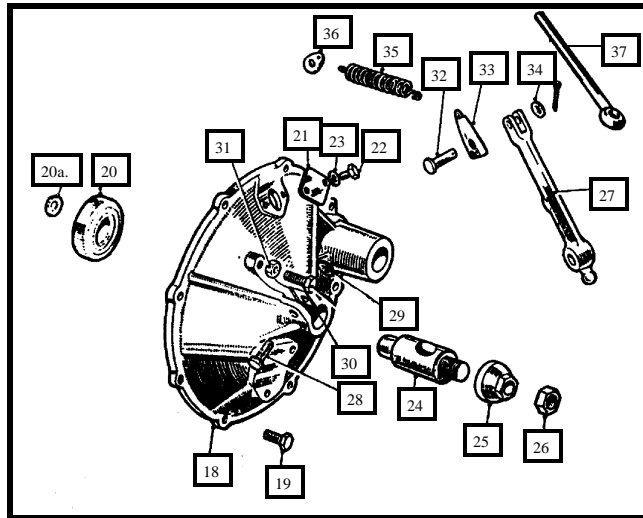
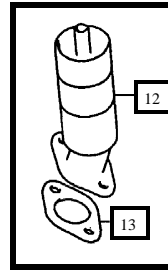
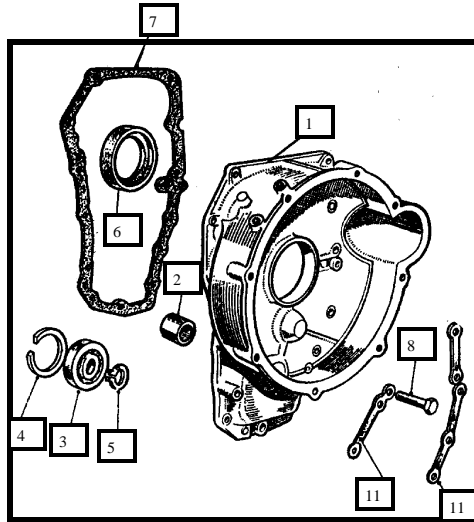

1.	22G1837	Clutch/Flywheel Housing	-----	1
2.	88G302	Idler Gear Bearing – 3 Synchro Remote Box 59' - 68' -----	-----	1
2.	13H7848	Idler Gear Bearing – 4 Synchro '69-'79 -----	-----	1
2.	DAM3745	Idler Gear Bearing & Sleeve – '79 Changeover-----	-----	1
2.	AHU1707	Idler Gear Bearing – Late '79 – '80-----	-----	1
3.	AAU8424	1st Motion Shaft Bearing -----	-----	1
4.	2A3643	Spring Ring – 1st Motion Shaft -----	-----	1
5.	CCN110	Circlip – Bearing -----	-----	1
6.	13H2934	Oil Seal – Clutch Housing-----	-----	1
7.	22A2237	Gasket – Clutch Housing-----	-----	1
8.	DAM7758	Bolt – Clutch Housing to Block – Long-----	-----	3
8.	DAM7753	Bolt – Clutch Housing to Block – Short -----	-----	3
11.	18G8086	Locktab Set – Clutch Housing -----	-----	1
12.	12G2619	Crankcase Vent -----	-----	1
13.	12G1114	Gasket -----	-----	1
18.	88G300	Clutch Cover-----	-----	1
19.	53K146	Bolt – Cover to Clutch Housing-----	-----	8
20.	GRB201	Clutch Release Bearing -----	-----	1
20a.	DAM2413	Clip – Retaining – for Bearing – '77 on -----	-----	1
21.	2A3635	Timing Hole Cover (used only) -----	-----	1
22.	MM800	Bolt – for Cover-----	-----	2
23.	MM811	Washer – Spring -----	-----	2
24.	22A180	Plunger – Clutch Throw Out – Press fit Brg. – to '76 -----	-----	1
24.	DAM1955	Plunger – Clutch Throw Out – Clip Retained Brg – '77 on -----	-----	1
25.	22A427	Plunger Stop (used only) -----	-----	1
26.	FNZ210	Locknut – Plunger Stop-----	-----	1
27.	2A3518	Clutch Throw Out Arm-----	-----	1
28.	CLZ628	Clevis Pin – Throw Out Arm -----	-----	1
29.	MM823	Washer – Plain -----	-----	1
30.	MM801	Bolt – Throw Out Arm Adjustment -----	-----	1
31.	MM806	Locknut -----	-----	1
32.	CLZ518	Clevis Pin – Arm to Push Rod-----	-----	1
33.	2A3601	Anchor Tab – for Clutch Return Spring -----	-----	1
34.	MM810	Washer – Plain -----	-----	1
35.	1G5999	Spring – Throw Out Arm Return -----	-----	1
36.	2A3600	Anchor Tab – for Clutch Return Spring – Slave End -----	-----	1
37.	13H396	Push Rod-----	-----	1