

ENGINE

Qty. Req'd.

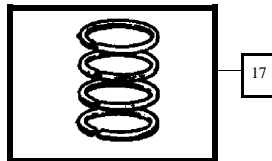
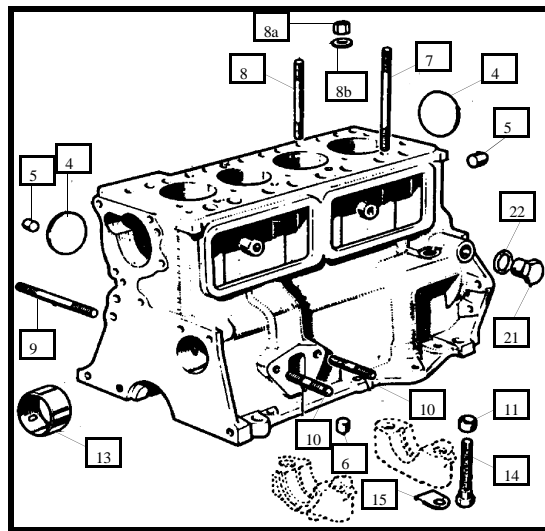
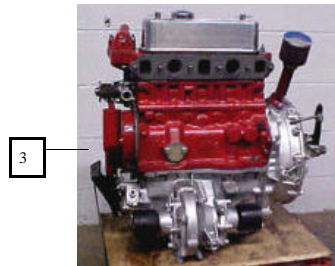
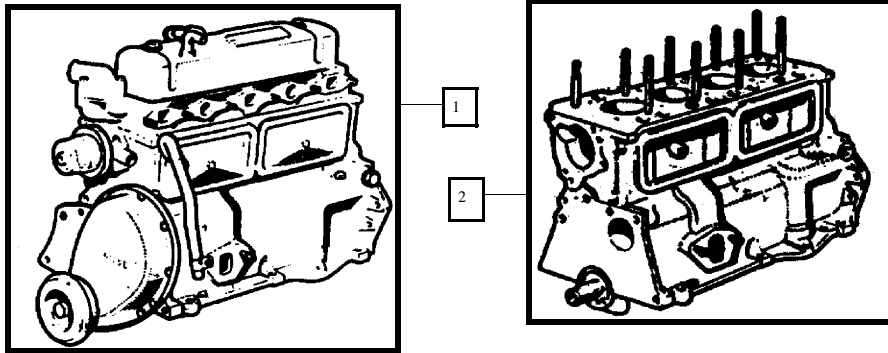

1.	MM1007	Engine Long Block – 998cc – Rebuilt (Exchange) ---	1
1.	MM1008	Engine Long Block – 1300cc – Rebuilt (Exchange)--	1
1.	MM1006	Engine Long Block – 1380cc – Rebuilt (Outright) ---	1
2.	MM001	Engine Short Block – 998cc – Rebuilt (Exchange)---	1
2.	MM002	Engine Short Block – 1300cc – Rebuilt (Exchange) -	1
2.	MM1005	Engine Short Block – 1380cc – Rebuilt (Outright) ---	1
3.	MM1011	Complete Engine & Trans – 998cc – Rebuilt (Exchange)-----	1
3.	MM1012	Complete Engine & Trans – 1300cc – Rebuilt (Exchange)----	1
3.	MM1013	Complete Engine & Trans – 1380cc – Rebuilt (Outright)-----	1
4.	2K8169	Frost Plug – 998cc -----	4
4.	AEC876	Frost Plug – 1300cc-----	5
4.	MM378	Frost Plug – 1275cc ‘S’ (Cup type) -----	4
5.	12G3503	Oil Gallery Plug -----	2
6.	2K1345	Oil Release Valve Passage Plug -----	2
7.	CAM150	Cylinder Head Stud – Long -----	4
8.	CAM151	Cylinder Head Stud – Short-----	5
8a.	51K1193	Nut – Cylinder Head-----	9
8b.	PWN106	Washer – Cylinder Head-----	9
8c.	CAM4545	Cyl. Head nut w/ washer (combined) not shown -----	9
9.	53K615	Stud – Oil Filter Head – Cartridge Type Filter -----	2
9.	CHS2613	Stud – Oil Filter Head – Spin-on Type Filter -----	2
10.	CHS2515	Stud – Fuel Pump -----	2
11.	2A54	Dowel – Main Bearing Cap -----	6
	MM402	Head Stud Set (consists of 7 & 8 – 9pce. + nuts)-----	1
	AHT280	Head Stud Set Competition kit (ARP) -----	1
13.	28G133	Bearing – Camshaft – 998cc-----	3
13.	8G2392	Bearing – Camshaft – 1300cc -----	3
14.	2A53	Main Cap Bolt -----	6
15.	6K927	Locktab – Main Bearing Cap – 998cc-----	6
16.	AE20773	Piston Assembly–with rings– 998cc–Std. To .060”(4 per set)-	1
16.	AE21251	Piston Assembly–with rings–1300cc–Std. To .060”(4 per set)	1
16.	AE20950	Piston Assembly–with rings–998cc Flat Tops (4 per set)-----	1
16.	AE21253	Piston Assembly–with rings–1275 ‘S’ Dished (4 per set) -----	1
16.	AE20739	Piston Assembly–with rings–1275 ‘S’ Flat Tops (4 per set) ---	1
17.	AE17926	Piston Ring Set–Std. To .060”-998cc fit AE20773 (4 per set)-	1
17.	R19520	Piston Ring Set–Std. To .060”-1275cc‘S’ (4 per set)-	1
17.	AE21576	Piston Ring Set–Std. To .060”-1300cc fit AE21251 (4 per set)	1
21.	53K2853	Plug – Block Drain -----	1
22.	6K638	Washer – Copper -----	1

ENGINE CONT'D

Qty. Req'd.

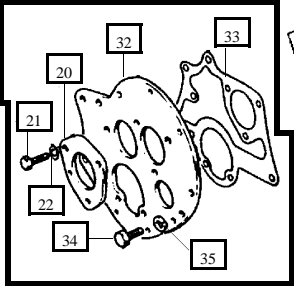
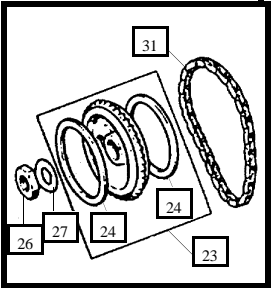
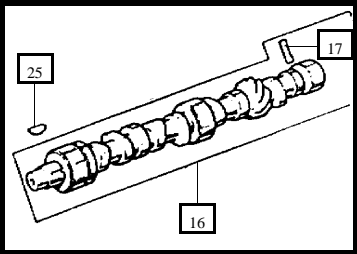
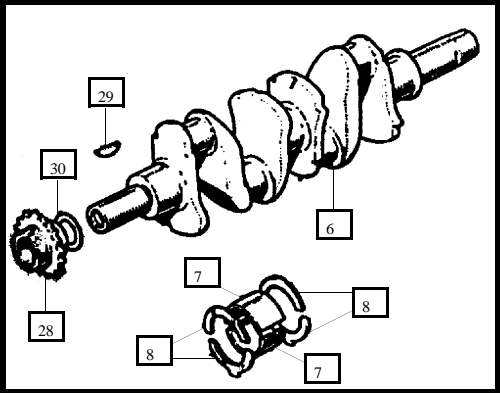
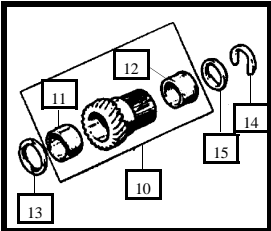
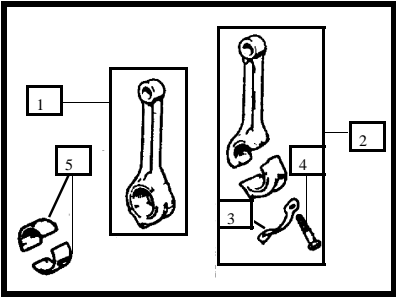

- 1. 12G126 Connecting Rod – Nos 1 & 3-----1
- 2. 12G123 Connecting Rod – Nos 2 & 4-----1
- 3. 2A660 Locktab Washer -----4
- 4. 12G2217 Bolt – Con Rod -----8
- 5. 8G2198 Bearing – Con Rod – Std. To .030” -----8
- 6. 12A1451 Crankshaft – (Exchange) State Size -----1
- 7. 8G2332 Bearings – Mains – Std. To .030” -----6
- 8. 8G2422 Crankshaft Thrust Washer – Std. .003”/.005” -----4
- 10. 22A1493 Crankshaft Primary Gear – 998cc -----1
- 11. 22G401 Bush – Front-----1
- 12. 22G109 Bush – Rear-----1
- Washer – Thrust – Primary Gear
- 13. 22A321 .110” - .112” (2.79 – 2.84mm)-----1
- 13. 22A322 .112” - .114” (2.84 – 2.89mm)-----1
- 13. 22A323 .114” - .116” (2.89 – 2.94mm)-----1
- 13. 22A324 .116” - .118” (2.94 – 2.99mm)-----1
- 13. 22A450 .118” - .120” (2.99 – 3.04mm)-----1
- 14. 22A319 Ring – Locking-- -----1
- 15. 88G549 Ring – Backing-- -----1
- 16. MM700 Series – KENT Camshafts & Cam Kits from Fast Road, to Full Race (Call for your requirements)
- 17. 2A299 Pin – Oil Pump Drive-----1
- 20. 2A84 Plate – Camshaft Locating -----1
- 21. MM837 Bolt – Front Plate – 1/4” Fine -----1
- 22. MM811 Washer – Front Plate – 1/4” Spring -----1
- 23. 2A85 Cam Gear – Single (replace w/ 12G4337) -----1
- 24. 8G549 Chain Tensioner – Rubber – (in Pairs) -----2
- 25. WKN505 Cam Key -----1
- 26. 6K629 Cam Nut -----1
- 27. 2A759 Locktab – Cam Gear -----1
- 28. 8G725 Gear – Crankshaft (Single) -----1
- 29. 6K836 Crankshaft Key-- -----1
- 30. 6K628 Shim Packing Washer -----1
- 31. 3H2127 Timing Chain (Single row)-----1
- 32. 2A970 Front Engine Plate – (Used Only) - -----1
- 33. 12G619 Gasket – Front Engine Plate – to 1979 -----1
- 33. CAM4700 Gasket – Front Engine Plate – 1979 on -----1
- 34. MM814 Bolt – Front Plate -----1
- 35. MM824 Washer – Front Plate-----1

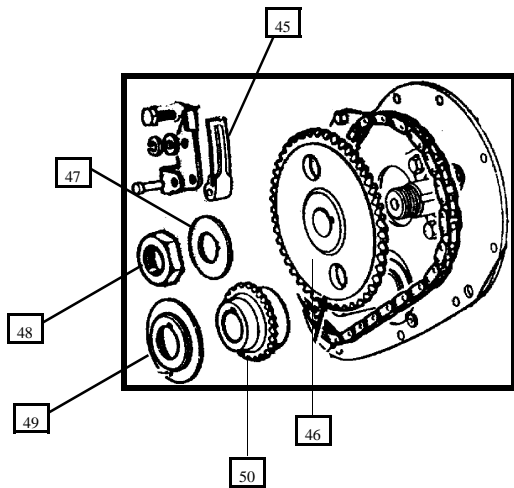
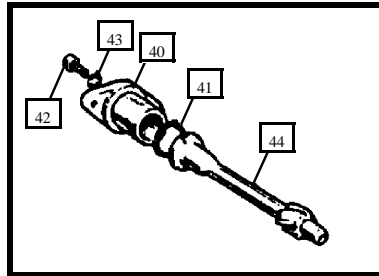
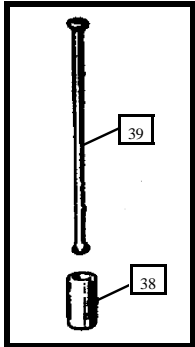

ENGINE CONT'D

Qty. Req'd.

38.	2A13	Camshaft Follower Set (Set of 8) --	-----1
39.	12A250	Push Rod (998c.c.) -----	8
40.	12A1136	Distributor Housing – (Used only)-	-----1
41.	13H2792	‘O’ Ring – Rubber-----	1
42.	MM837	Bolt – Distributor Housing-----	1
43.	MM811	Washer – Distributor Housing -----	1
44.	12G4499	Spindle – Distributor Drive (Used only)-----	1
45.	12G2621	Tensioner – Timing Chain – 1979 on -----	1
46.	12G4337	Cam Gear – Simplex-----	1
47.	2A759	Camshaft Locktab -----	1
48.	6K629	Camshaft Nut-----	1
49.	12A1148	Oil Thrower-----	1
50.	8G725	Crankshaft Gear (Single)-----	1

ENGINE CONT'D

Qty. Req'd.

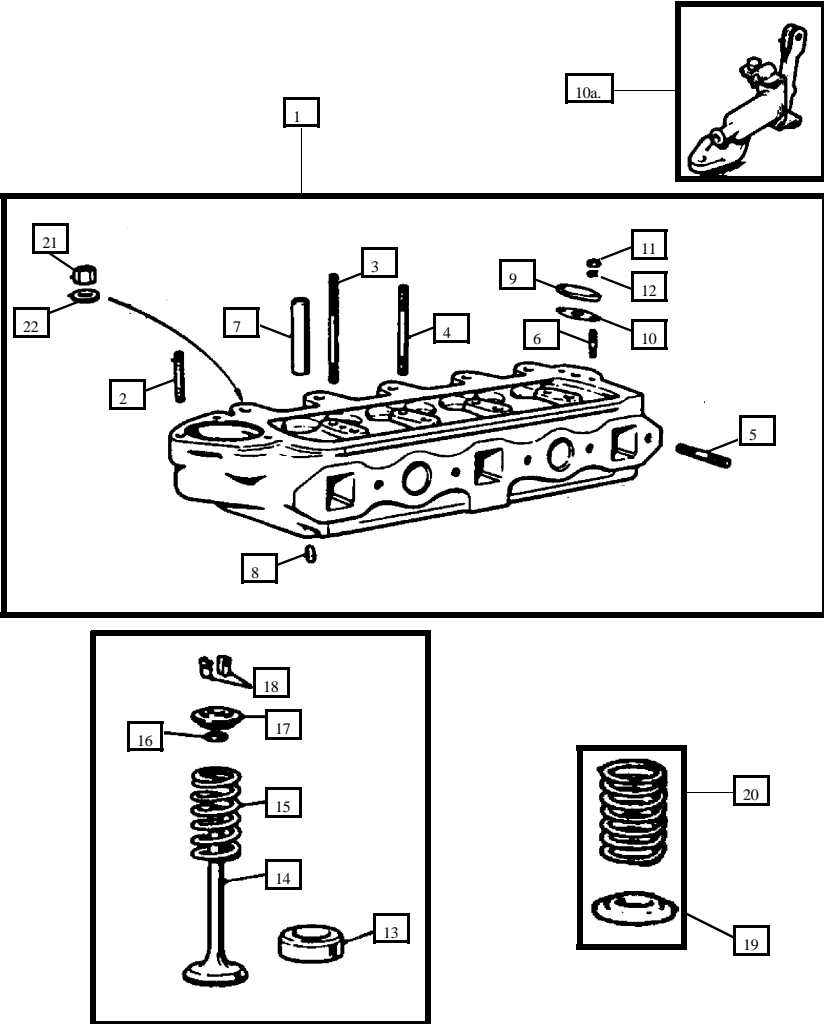

1.	CAM4004	Cyl Head Assembly – 998cc – Rebuilt – (Exchange) -	1
1.	12G295	Cyl Head Assembly – 998cc Cooper – Rebuilt – (Exchange) --	1
2.	CHS2515	Stud – Thermostat Housing-----	3
3.	51K885	Stud – Rocker Assembly – Long-----	2
4.	51K1473	Stud – Rocker Assembly – Short -----	2
5.	GEX7257	Stud – Exhaust Manifold-----	6
6.	53K402	Stud – Water Control Valve-----	2
7.	12A186	Guide – Inlet & Exhaust Valve -----	8
7.	MM469	Guide – Bronze – Inlet & Exhaust Valve -----	8
8.	2K1345	Plug – Oil Hole -	1
9.	2A180	Blank Plate	1
10.	88G221	Gasket – Heater Control Valve -----	1
10a.	88G601	Heater Control Valve -----	1
11.	MM806	Nut -----	2
12.	MM811	Washer – Spring -----	2
13.	2A639	Valve Seat – INLET -----	8
13.	2A640	Valve Seat – EXHAUST -----	8
13.	MM571	Valve Seat – INLET – Hardened -----	8
13.	MM572	Valve Seat – EXHAUST – Hardened-----	8
13.	MM573	Valve Seat – EXHAUST (1275 c.c.) – Hardened-----	8
14.	2A877	Valve – INLET – 1.094” – (Early Split Cotter)-----	4
14.	AEA434	Valve – EXHAUST – 1.00” - (Early Split Cotter) ----	4
14.	AEA399	Valve – INLET – Cooper 1.51” - (Early Split Cotter) -----	4
14.	12A1986	Valve – INLET – 1.094” - (Late Split Cotter) -----	4
14.	12A1987	Valve – EXHAUST – 1.00” - (Late Split Cotter)-----	4
15.	VS452	Valve Spring – Std. Outer -----	8
16.	2A879	Valve Stem Seal -----	8
16.	MM453	Valve Spring Set – Inner & Outer – Piper Heavy Duty -----	8
17.	88G616	Valve Spring Cap – (Early Split Cotter) -----	8
17.	88G617	Valve Spring Cap – (Late Split Cotter) -----	8
18.	2A11	Valve Cotter – (Early Clip Type)-----	8pr.
18.	88G459	Valve Cotter – (Late Non Clip Type)-----	8pr.
19.	AEA403	Inner Valve Spring Locator – (Double Spring) -----	8
20.	AEA401	Valve Spring – Inner – Cooper -----	8
21.	51K1193	Nut – Cylinder Head-----	9
22.	PWN106	Washer – Cylinder Head -----	9

ENGINE CONT'D

Qty. Req'd.

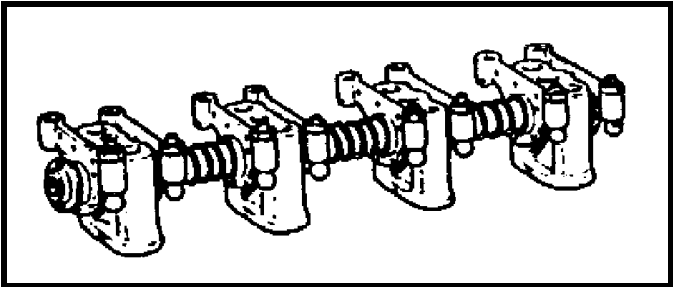

1.	12A1950	Rocker Shaft -----	-----1
1.	12A1950T	Rocker Shaft – Tuftrided -----	-----1
2.	12G1926	Pedastal – Rocker Shaft – Oil Feed Hole -----	-----3
3.	12G1927	Pedastal – Rocker Shaft – Tapped -----	-----1
4.	2A515	Plate – Rocker Pedastal Locking ---	-----1
5.	2A258	Screw – Lockplate -----	-----1
6.	2A21	Bush – Rocker Arm -----	-----8
7.	12A1215	Screw – Tappet Adjusting -----	-----8
8.	6K654	Locknut -----	-----8
9.	6K556	Spring – Rocker Spacing -----	-----3

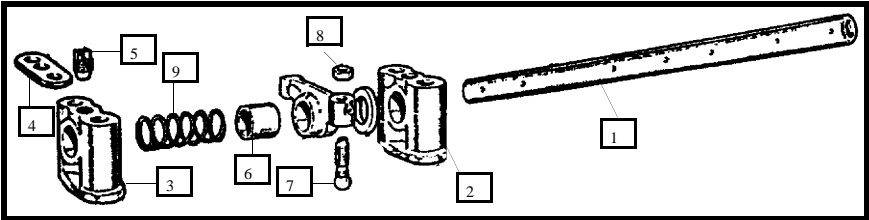

ENGINE CONT'D

Qty. Req'd.

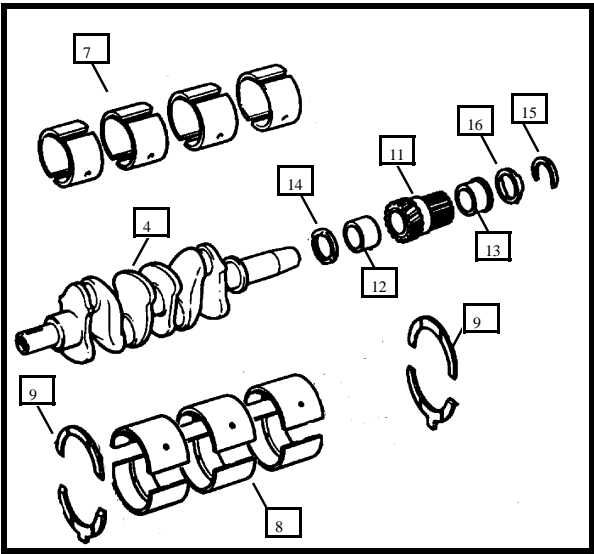
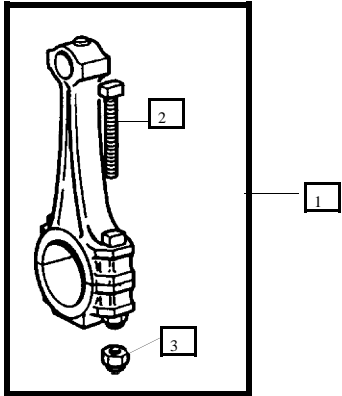

1.	12G1506	Connecting Rod – 1300cc-----	-----1
2.	12G1300	Con Rod Bolt ----	-----8
3.	13H5872	Con Rod Nut-----	-----8
1.	AEG520	Connecting Rod – 1275 ‘S’ - Reconditioned -----	-----4
2.	AEG519	Con Rod Bolt – ‘S’ -----	-----8
3.	AEG147	Con Rod Nut – ‘S’-----	-----8
2.	MM1253	Con Rod Bolt Set 1275 ‘S’-----	-----1
2.	MM1254	Con Rod Bolt Set – Comp. – 1300cc – by ARP -----	-----1
4.	12G1683	Crankshaft – 1300cc – Exchange--	-----1
4.	AEG479	Crankshaft – 1275 ‘S’ - (ENB40) - Exchange -----	-----1
7.	8G2553	Con Rod Bearings – 1300cc – (Std. To .030”)-----	-----8
7.	VPR572	Con Rod Bearings – 1275 ‘S’ - (Std. To .030”)-----	-----8
8.	8G2391	Main Bearings – 1300cc – (Std. To .040”) -----	-----6
8.	VPM91120	Main Bearings – 1275 ‘S’ - (Std. To .040”)-----	-----6
9.	VPW41	Crankshaft Thrust Washers – 1300cc -----	-----4
11.	22G1053	Primary Gear – 1300cc & 1275 ‘S’ (pre A'+)-----	-----1
12.	22G770	Primary Gear Bush – Front-----	-----1
13.	22G109	Primary Gear Bush – Rear-----	-----1
		- Primary Gear Thrust Washer -	
14.	22A546	.112” - .114” (2.84 – 2.89mm)	
14.	22A547	.114” - .116” (2.89 – 2.94mm)	
14.	22A548	.116” - .118” (2.94 – 2.99mm)	
14.	22A549	.118” - .120” (2.99 – 3.04mm)	
14.	22A550	.120” - .124” (3.04 – 3.15mm)	
15.	22A319	Primary Gear Ring Lock -----	-----1
16.	88G549	Primary Gear Ring -----	-----1
17.	AGA619	Centre Main Cap set 4 Bolt – 1300cc – Comp. (Not shown)---	-----1

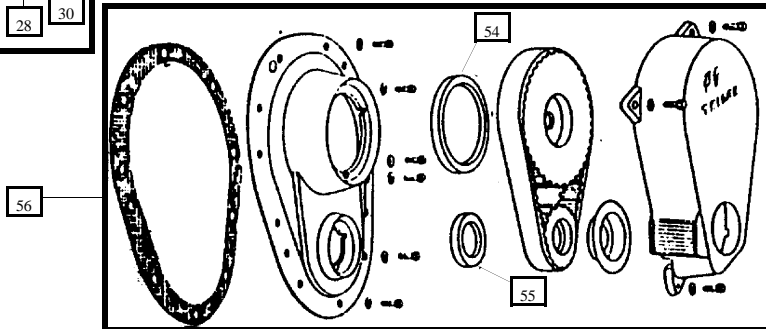
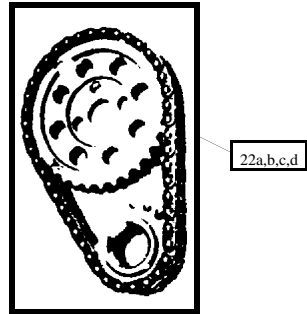
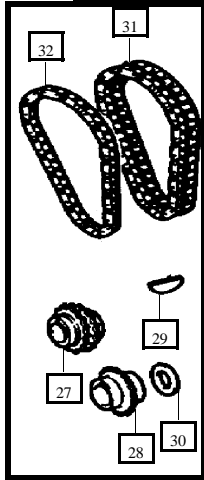
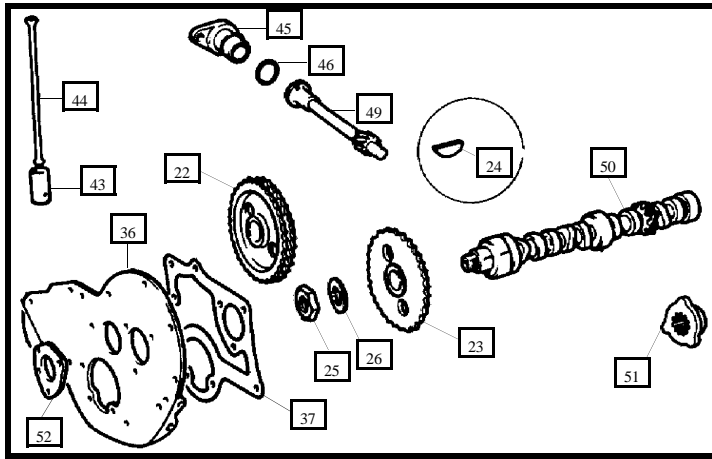

ENGINE CONT'D

Qty. Req'd.

22.	12G1397	Cam Gear – Duplex – (see 22a/b/c/d)-----	1
22a.	MM505	Cam Gears – Duplex Set – (2 Gears & Chain)-----	1
22b.	MM506	Cam Gears – Duplex Set – (2 Gears & Chain Lightened.) -----	1
22c.	MM454	Cam Gears – Duplex – Vernier Adjustable – Piper -----	1
22d.	MM463	Cam Gears – Duplex Set – (2 Gears & Chain – Adj. Vernier)-1	
23.	12G4337	Cam Gear – Simplex-----	1
24.	WKN505	Key – Cam Gear -----	1
25.	6K629	Nut – Cam Gear -----	1
26.	2A759	Locktab Washer – Cam Gear-----	1
27.	12G1699	Crank Gear – Duplex – (See 22a) - -----	1
28.	8G725	Crank Gear – Simplex -----	1
29.	6K836	Key – Crank Gear -----	1
30.	6K628	Shim Washer -----	1
31.	2H4905	Timing Chain – Duplex -----	1
32.	3H2127	Timing Chain – Simplex-----	1
36.	AEG161	Front Engine Plate – Duplex (used only)-----	1
36.	12G2626	Front Engine Plate – Simplex (used only) -----	1
37.	12G619	Gasket – Front Engine Plate to '79 -----	1
37.	CAM4700	Gasket – Front Engine Plate – late '79 & '80-----	1
43.	2A13	Cam Follower (Set of 8)-----	1
43.	MM452	Cam Follower – Heavy Duty – by Piper (Set of 8)-----	1
44.	12A250	Push Rod 998cc - -----	8
44.	AEG314	Push Rod 1300cc -----	8
45.	12A1136	Distributor Housing (used only) ---	1
46.	13H2792	'O' Ring – Dist. Housing-----	1
49.	12G4499	Spindle – Dist. Drive (used only) - -----	1
50.	MM700	Cam Kit – Fast Road/Rally/Race -- -----	1
		(call for requirements)	
51.	CHM108	Camshaft Drive – Spider-----	1
52.	2A84	Camshaft Plate -- -----	1
54.	MM504	Oil Seal – Large -----	1
55.	MM503	Oil Seal – Small -----	1
56.	MM501	Timing Belt Conversion Kit-----	1

ENGINE CONT'D

Qty. Req'd.

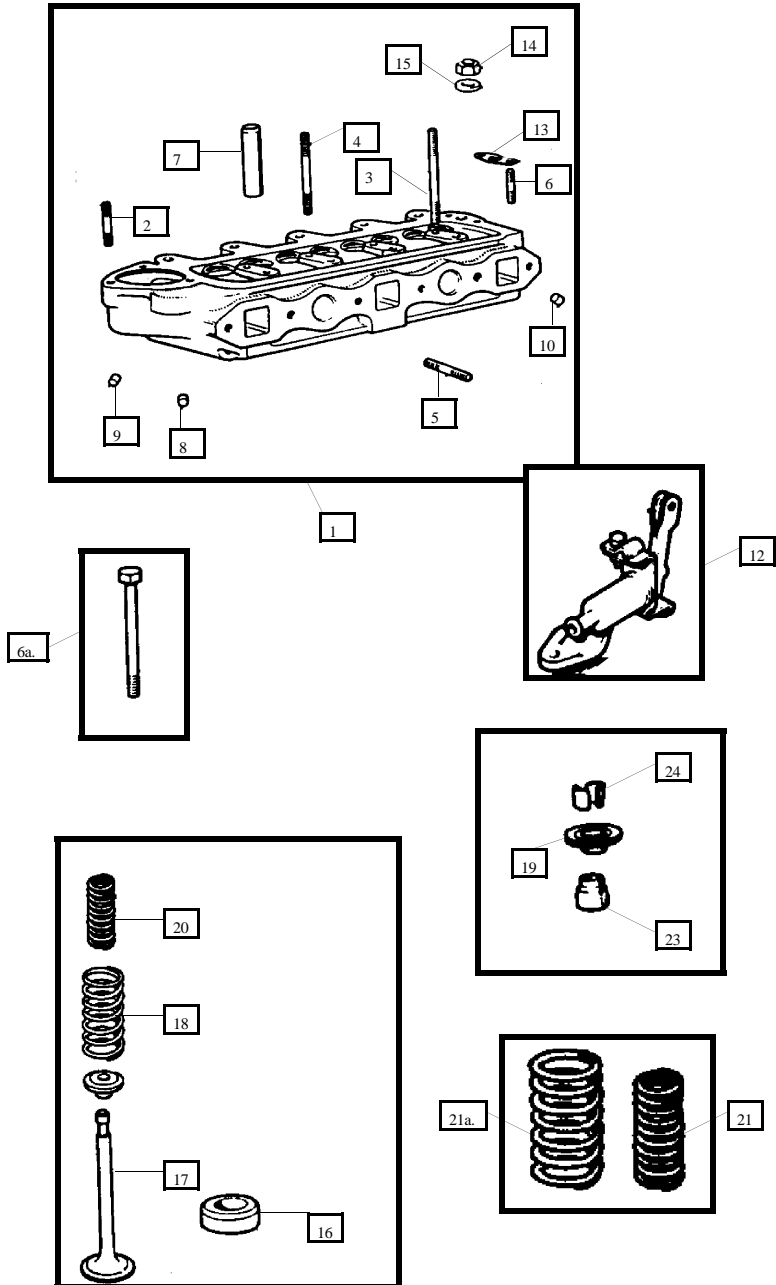

1.	12G1316	Cyl Head Assembly – 1300 – Bare -----	1
1.	12G1316R	Cyl Head Assembly – 1300 – Rebuilt-----	1
1.	12G940R	Cyl Head Assembly – 1275 ‘S’ - Rebuilt-----	1
2.	CHS2515	Stud – Thermostat Housing-----	3
3.	51K885	Stud – Rocker Assembly – Long--- -----	2
4.	51K1473	Stud – Rocker Assembly – Short--- -----	2
5.	53K507	Stud – Exhaust Manifold-----	6
6.	53K402	Stud – Water Control Valve -----	2
6a.	AEA248	Bolt – Head ‘S’ -- -----	1
7.	12G1111	Guide – Inlet & Exhaust Valve – 1300cc -----	8
7.	MM358	Guide – Inlet & Exhaust Valve – Bronze 1300cc -----	8
7.	12G1963	Guide – Inlet & Exhaust Valve – 1275 ‘S’ -----	8
8.	2K1345	Plug – Oil Hole-- -----	1
9.	12G2092	Plug – Water Hole-----	1
10.	AEA771	Plug – Water & Dowel Hole-----	1
12.	88G601	Water Control Valve -----	1
13.	88G221	Gasket – Water Control Valve -----	1
14.	MM806	Nut-----	2
15.	MM811	Washer – Spring -----	2
16.	12G1089	Valve Seat Insert – Inlet-----	4
16.	12G2675	Valve Seat Insert – Exhaust -----	4
17.	12G941	Valve – Inlet – 1300 – (Late Collet) 1.307” -----	4
17.	12G1322	Valve – Exhaust – 1300 – (Late Collet) 1.151”-----	4
17.	AEA592	Valve – Inlet – 1275 ‘S’ (Late Collet) 1.401”-----	4
17.	AEA765	Valve – Exhaust – 1275 ‘S’ (Late Collet) 1.215”-----	4
18.	12G1136	Valve Spring – 1300 -----	8
19.	88G617	Valve Spring Cap – 1300 -----	8
20.	12G1137	Valve Spring Inner – 1275 ‘S’ -----	8
21.	AEA767	Valve Spring Outer – 1275 ‘S’-----	8
21a.	MM453	Valve Spring Set – Inner & Outer – by Piper -----	8
19.	88G616	Valve Spring Cap – 1275 ‘S’-----	8
23.	AEA327	Valve Seal – Cup Type – Intake --- -----	4
24.	88G459	Valve Collet – ‘69 on -----	8pr
24.	2A11	Valve Collet – to ‘69-----	8pr

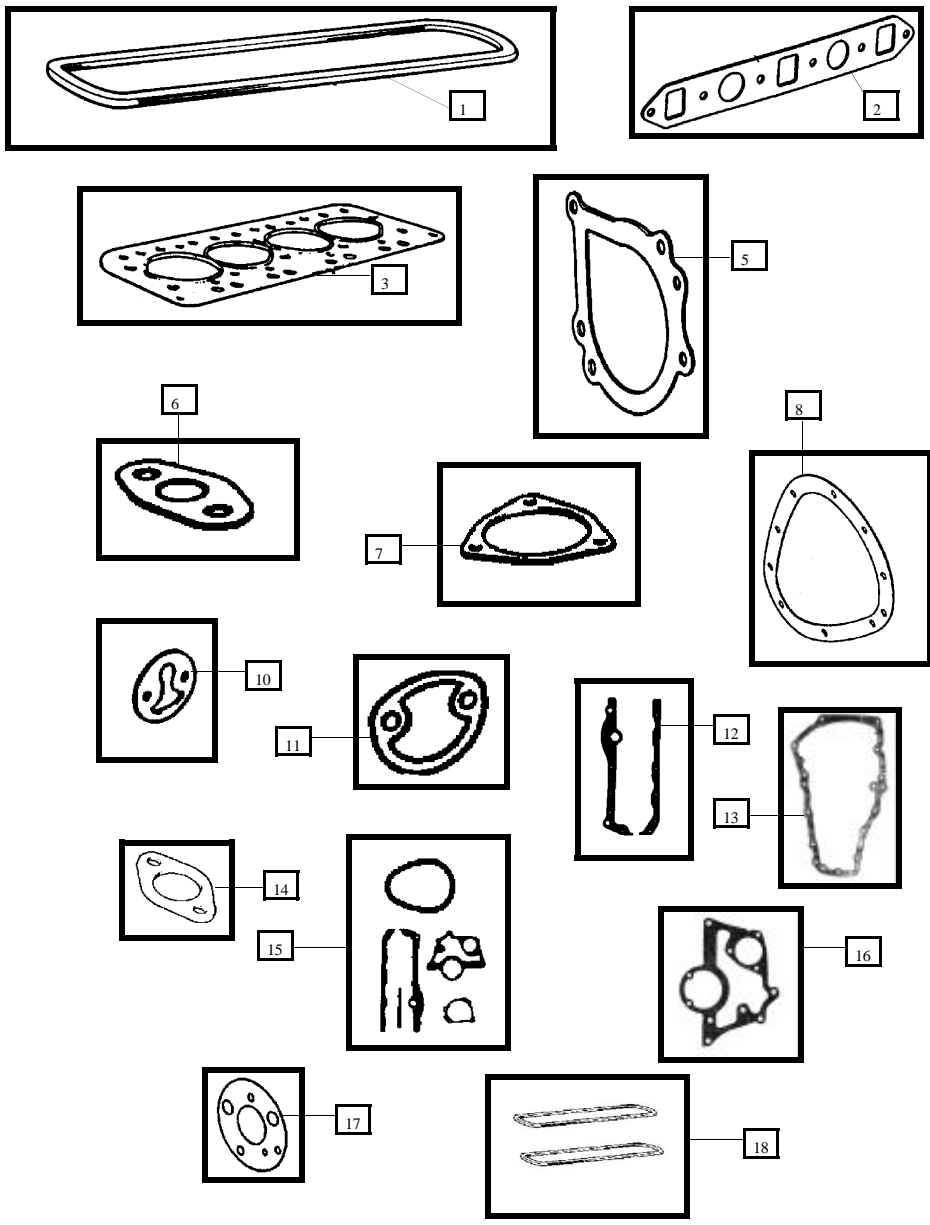

GASKETS

Qty. Req'd.

1.	GEG401	Rocker Cover Gasket -----	1
1.	GEG417	Rocker Cover Gasket – ‘S’ - Fibre -----	1
2.	GEG601	Manifold Gasket -----	1
2.	MM391	Manifold Gasket – LCB Header (Big) -----	1
3.	MM396	Head Gasket – 998cc – Aluminum -----	1
3.	GEG302	Head Gasket – 998cc – Copper ---	1
3.	MM428	Head Gasket – 1275cc – Aluminum-----	1
3.	GEG301	Head Gasket – 1275cc – Copper - -----	1
3.	MM433	Head Gasket – 1275cc – Turbo--- -----	1
3.	12G2230	Head Gasket – 1275cc – ‘S’ -----	1
3.	TAM1521	Head Gasket – 1.3l A+‘ race grade (black Payen) - -----	1
4.	MM380	Head Set – 998cc – Aluminum --- -----	1
4.	MM381	Head Set – 998cc – Copper -----	1
4.	MM382	Head Set – 1275cc – Aluminum - -----	1
4.	MM383	Head Set – 1275cc – Copper-----	1
5.	88G215	Water Pump Gasket -----	1
6.	88G221	Water Control Valve Gasket-----	1
7.	GTG101	Thermostat Gasket-----	1
8.	12A956	Timing Cover Gasket – to ‘79-----	1
9.	12G2625	Timing Cover Gasket – ‘79 on (not shown) -----	1
10.	88G402	Oil Filter Housing Gasket – Cartridge -----	1
11.	12A2035	Oil Filter Housing Gasket – Spin On -----	1
12.	MM434	Rail Gasket Set -----	1
12.	GEG502	Rail Gasket Set – O/E-----	1
13.	22A2237	Clutch Housing Gasket -----	1
13.	GUG705563	Clutch Housing Gasket – O/E-----	1
14.	12G1114	Clutch Housing Vent Gasket -----	1
15.	MM389	Conversion Set Gasket-----	1
16.	12G619	Front Plate Gasket – to ‘79-----	1
16.	CAM4700	Front Plate Gasket – ‘79 on-----	1
17.	88G411	Oil Pump Gasket-----	1
18.	12A1175	Side Cover Gasket (rubber) -----	1

ROCKER COVERS

Qty. Req'd.

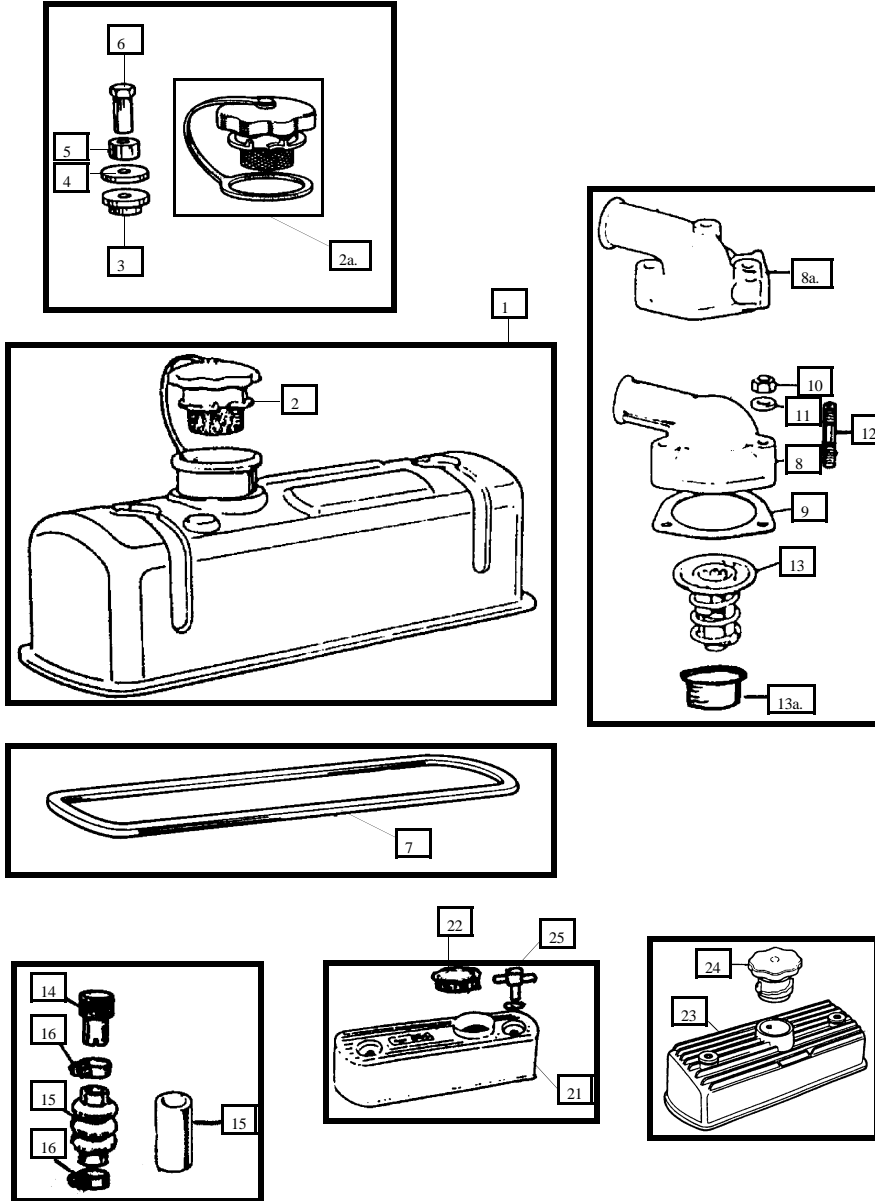

1.	LDR10074	Cover – Rocker--	-----	1
2.	GFE6003	Cap – Oil Filler – Vented (O/E) ---	-----	1
2.	MM242	Cap – Oil Filler – Vented – Repro. ---	-----	1
2a.	12A402	Cap – Oil Filler – Non Vented-----	-----	1
3.	12A1358	Bush – Rocker Cover – Rubber ----	-----	2
4.	1A2156	Cupwasher -----	-----	2
5.	1B2925	Spacer -----	-----	2
6.	2A150	Sleevenut-----	-----	2
7.	GEG401	Gasket – Rocker Cover – Cork-----	-----	1
7.	GEG417	Gasket – Rocker Cover – Fibre – 1275 ‘S’ - 11 Stud -----	-----	1
8.	12G103	Thermostat Housing – to ‘74-----	-----	1
8a.	CAM4044	Thermostat Housing – ‘74 on NLA (used only)-----	-----	1
9.	GTG101	Gasket – Thermostat Housing-----	-----	1
10.	MM820	Nut-----	-----	3
11.	MM824	Washer – Spring -----	-----	3
12.	CHS2515	Stud -----	-----	3
13.	MM404	Thermostat 74C – 160F (summer) -----	-----	1
13.	MM405	Thermostat 82C – 180F (midrange) -----	-----	1
13.	MM406	Thermostat 88C – 190F (winter) --	-----	1
13a.	11G176	Thermostat Blanking Sleeve-----	-----	1
14.	12A2075	Adaptor – By-Pass Hose – 1” Long -----	-----	1
14.	88G618	Adaptor – By-Pass Hose – 1/2” Long -----	-----	1
15.	12A1093	Hose – By-Pass – Straight w/ clips -----	-----	1
15.	MM499	Hose – By-Pass – Fluted w/clips --	-----	1
16.	MM832	Clip – By-Pass Hose-----	-----	2
21.	MM206	Rocker Cover – Alloy – Polished w/cap -----	-----	1
22.	MM241	Cap – Oil Filler – Chrome – for MM206 -----	-----	1
23.	MM207	Rocker Cover – Alloy – Black-----	-----	1
23.	MM208	Rocker Cover – Alloy – Red-----	-----	1
23.	CAM6822	Rocker Cover – Alloy – Polished --	-----	1
24.	GFE6007	Cap – Oil Filler – for CAM6822---	-----	1
25.	MM218	‘T’ Bar Sleeve Nut – (Set of 2)-----	-----	2