

OIL PUMPS & FILTERS

Qty. Req'd.

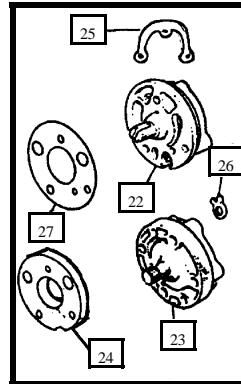
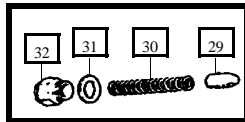
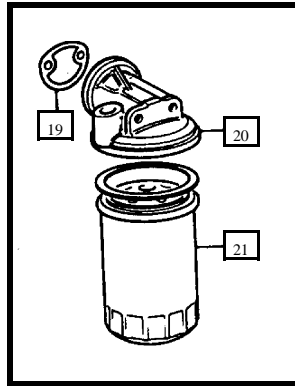
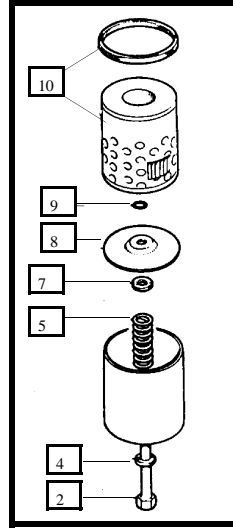
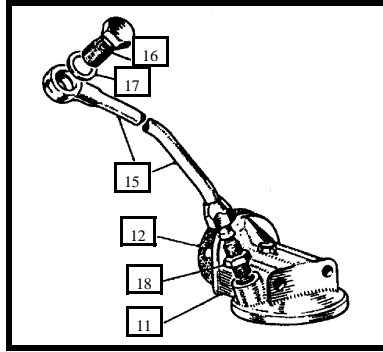

2.	37H689	Bolt – Filter Can -----	1
4.	17H2281	Seal – Rubber-----	1
5.	500319	Spring -----	1
7.	7H28	Washer – Rubber -----	1
8.	17H1148	Pressure Plate-----	1
9.	27H2573	Circlip – Centre Bolt-----	1
10.	GFE103	Filter Element & Seal-----	1
11.	37H690	Filter Head – NLA – (used only) --	1
12.	88G402	Gasket – Filter Head to Block -----	1
15.	88G538	Pipe – Filter Head to Block -----	1
16.	2A715	Banjo Bolt-----	1
17.	AED172	Washer – Copper -----	2
18.	TCZ106	Connector – Pipe to Filter Head ---	1
19.	12A2035	Gasket – Filter Head to Block – Spin on Filter-----	1
20.	12A2032	Filter Head -----	1
21.	GFE166	Oil Filter – Spin on-----	1
22.	12G793	Oil Pump – Pin Drive – 998cc -----	1
22.	AEG410	Oil Pump – Pin Drive – 1275 ‘S’ --	1
23.	12G2790	Oil Pump – Spider Drive – 1300cc -----	1
	GLP110	Oil Pump – Slot – Turbo -----	1
	GLP138	Oil Pump – Slot – 1300 ‘A’ Plus --	1
24.	MM357	Oil Pump Distance Spacer – for Modified Blocks -----	1
25.	12G926	Oil Pump Locktab – Pin Drive Pump-----	1
26.	12G2097	Oil Pump Locktab – Spider Drive Pump – Long -----	1
26.	12G2098	Oil Pump Locktab – Spider Drive Pump – Short-----	1
27.	88G411	Gasket – Oil Pump -----	1
29.	12H865	Oil Pressure Release Valve -----	1
30.	6K853	Spring – Oil Valve -----	1
30.	AEA536	Spring – Oil Valve – 1275 ‘S’ only -----	1
31.	6K431	Washer – Copper -----	1
32.	12A1851	Nut Cap -----	1

OIL PRESSURE

Qty. Req'd.

33.	12A1263	Oil Level Dipstick -----	-----	1
34.	12G107	Dipstick Tube – Metal – -----	-----	1
37.	2A269	Union – Oil Pressure – Block Fitting -----	-----	1
38.	CAM4202	Oil Pressure Pipe – Block to Hose -----	-----	1
39.	MM521	Oil Pressure Hose – with Clamps -- -----	-----	1
40.	21A804	Oil Pressure Pipe – Hose to Guage -----	-----	1
	MM531	Braided Oil Line Kit (replaces 37 to 40) -----	-----	1
41.	GPS133	Oil Pressure Switch – Sender to Dash Light – MK1 -----	-----	1
42.	88G210	Oil Drain Plug – Magnetic -----	-----	1
43.	AED172	Washer – Copper -----	-----	1

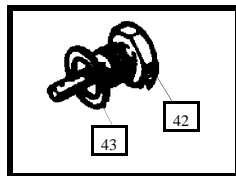
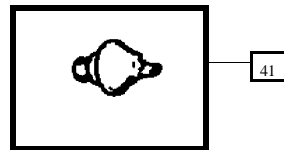
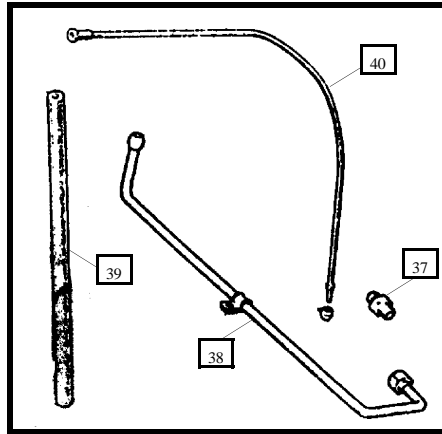
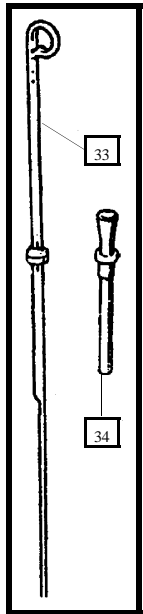

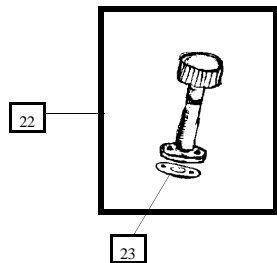
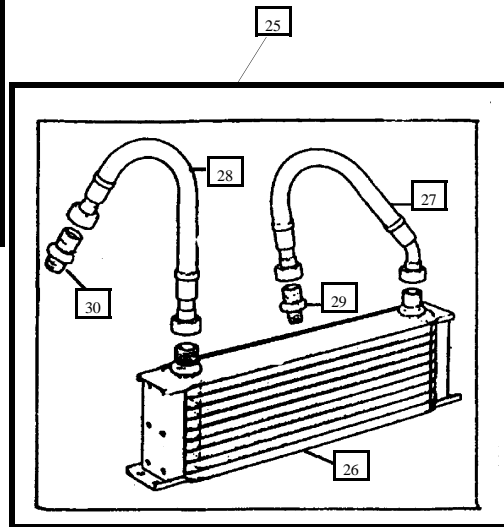
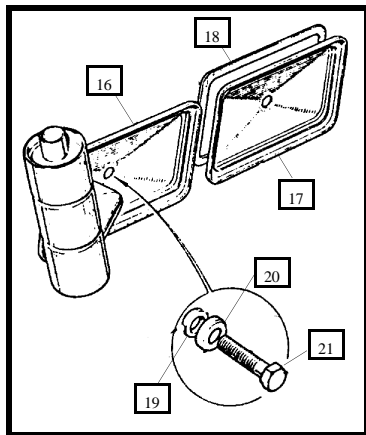
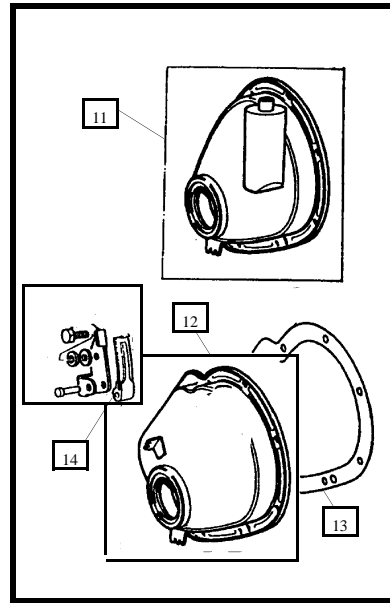
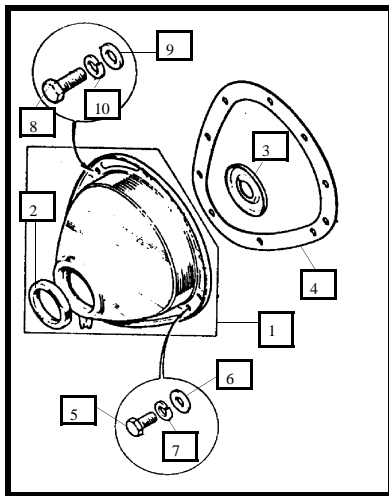

TIMING COVERS & OIL COOLERS

Qty. Req'd.

1.	12G2506	Timing Cover – to ‘79 (Reconditioned only)	-----1
2.	88G561	Seal – Timing Cover	-----1
3.	12A1148	Oil Thrower	-----1
4.	12A956	Gasket – Timing Cover	-----1
5.	MM800	Bolt – Cover to Mounting Plate	-----6
6.	MM810	Washer – Plain	-----6
7.	MM811	Washer – Spring	-----6
8.	MM814	Bolt – Cover to Block	-----4
9.	MM823	Washer – Plain	-----4
10.	MM824	Washer – Spring	-----4
11.	12G2507	Timing Cover w/ Breather (Reconditioned only) “1275”	-----1
12.	CAM4904	Timing Cover – ‘79 on (shaped for tensioner)	-----1
12a.	CAM4868	Timing Cover w/ breather (shaped for tensioner)	-----1
13.	12G2625	Gasket – Timing Cover	-----1
14.	12G2621	Timing Chain Tensioner Pad	-----1
16.	12A1212	Side Cover – Front – with Separator – 998cc & ‘S’ (Reconditioned only)	-----1
17.	12A1386	Side Cover – Rear – Plain – 998cc & ‘S’ (Reconditioned only)	-----1
18.	12A1175	Gasket – Side Cover – Rubber	-----2
19.	12A1176	Seal – Side Cover	-----2
20.	12A1177	Cup Washer – for Seal	-----2
21.	606171	Bolt – Side Cover	-----2
22.	MM695	Crankcase Vent Kit – 1275cc – with K&N Filter	-----1
23.	12G1114	Gasket – Crankcase Vent	-----1
25.	MM351	Oil Cooler Kit – (Stack & Hoses)	-----1
26.	MM347	Oil Cooler Stack – 13 Row	-----1
27.	MM352	Oil Cooler Hose – Filter Head to Stack	-----1
28.	MM353	Oil Cooler Hose – Stack to Block	-----1
29.	MM324	Fitting – Filter Head	-----1
30.	MM323	Fitting – Block	-----1
	MM399	Oil Cooler Pipe Kit (with fittings attached)	-----1

WATERPUMPS, FANS & PULLEYS

Qty. Req'd.

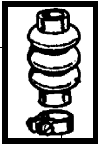
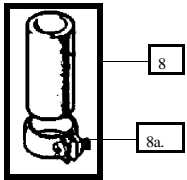
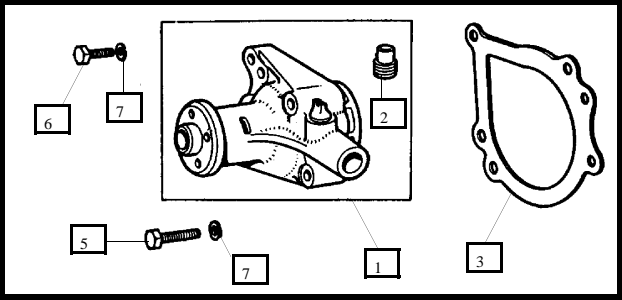

8a.

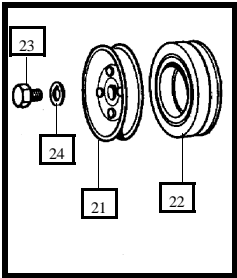
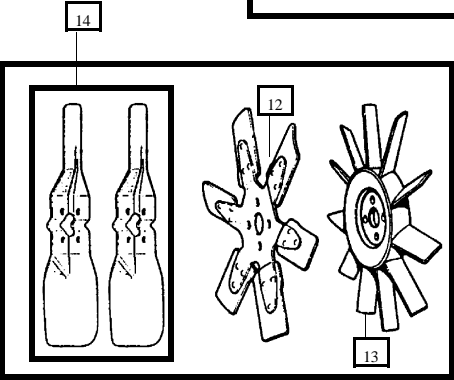
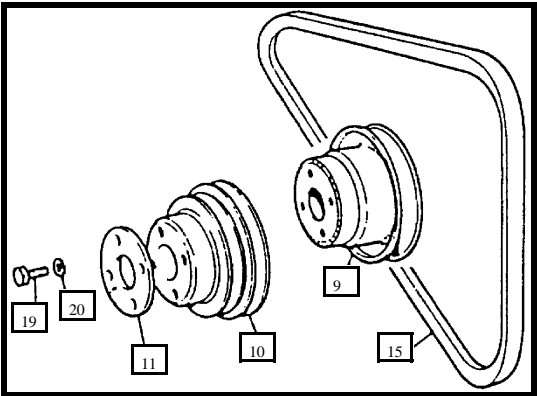

- 1. GWP132 Water Pump – Std. -----1
- 1. GWP134 Water Pump – Hvy Duty – Larger Impeller -----1
- 2. 88G618 Adaptor – By-Pass – 1/2” Long -----1
- 2. 12A2075 Adaptor – By-Pass – 1 “ Long -----1
- 3. 88G215 Gasket – Water Pump -----1
- 5. HZS515 Bolt – Water Pump to Block – Long -----2
- 6. HZS510 Bolt – Water Pump to Block – Short -----2
- 7. MM824 Washer – Spring -----4
- 8. MM499 By-Pass Hose – Fluted – with Clamps -----1
- 8. 12A1093 By-Pass Hose – Straight – with Clamps -----1
- 8a. MM832 Hose Clamp -----2
- 9. 2A601 Pulley – Fan & Water Pump – Pressed Steel -----1
- 10. 12G1542 Pulley – Fan & Water Pump – Cast Steel -----1
- 11. 12A312 Distance Piece --- -----1
- 12. 12G2129 Fan Cooling – 11 Blade – Plastic -- -----1
- 13. 2A998 Fan Cooling – 6 Blade – Metal ---- -----1
- 14. 2A997 Fan Cooling – 4 Blade – Metal (2x2 blades) -----1
- 15. GCB10813 Fan Belt – for Alternator Applications 70’ - on -----1
- 15. GCB10825 Fan Belt – for Generator Applications 59’ - 69’ -----1
- 19. MM801 Bolt – Fan to Pump – use with 2A601 -----4
- 19. MM803 Bolt – Fan to Pump – use with 12G1542 -----4
- 20. MM811 Washer – Spring -----4
- 21. 2A940 Crankshaft Pulley – Pressed Steel - -----1
- 22. 88G305 Crankshaft Pulley – with Damper – 1300 -----1
- 23. 12A283 Bolt – Crankshaft Pulley Retaining -----1
- 24. 12A398 Locktab -----1

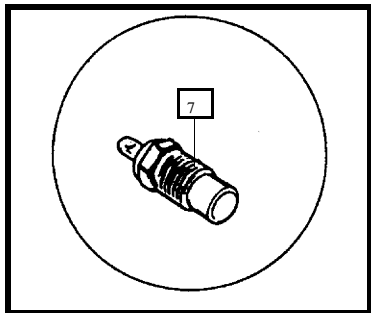
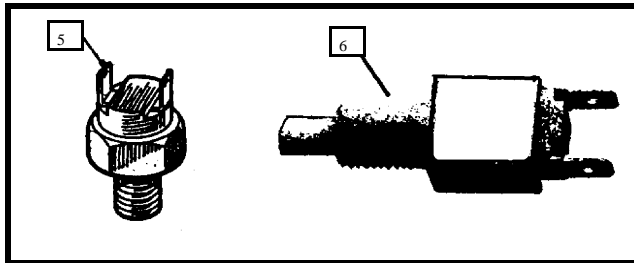
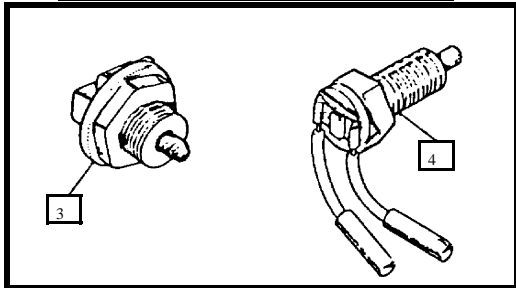
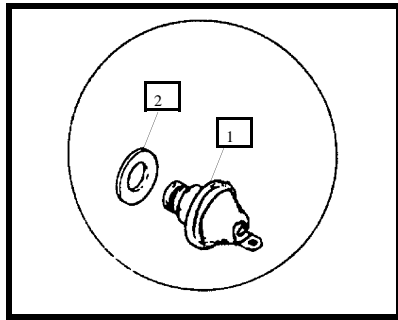

PRESSURE SWITCHES

Qty. Req'd.

- 1. GPS133 Oil Pressure Switch – Dash Light Indicator – MKI-----1
- 2. 6K464 Washer – Copper -----1
- 3. GAE131 Reverse Light Switch – Remote Trans. Pre '74-----1
- 4. GAE133 Reverse Light Switch – Rod Trans. '74 on -----1
- 5. 13H1731 Brake Light Switch – Hydraulic – (mounts on frt. Subframe) --1
- 6. 13H3735 Brake Light Switch – Electric – (mounts above brake pedal) -1
- AAU1752A Brake Pressure Failure Switch (not shown) -----1
- 7. 88G580 Temperature Sending Switch – Water-----1