

ENGINE MOUNTS & STABILIZERS

Qty. Req'd.

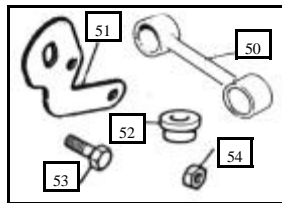
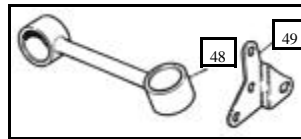
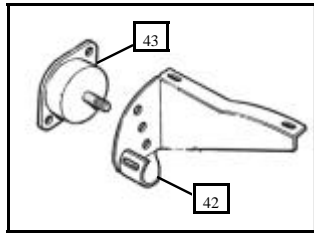
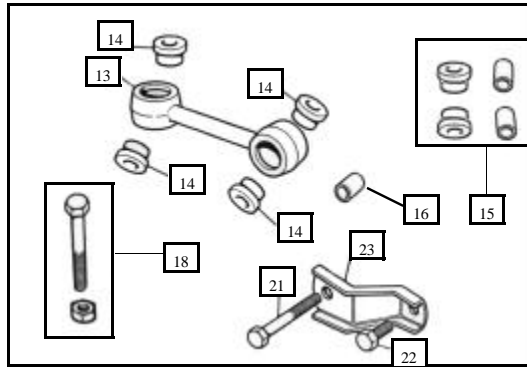
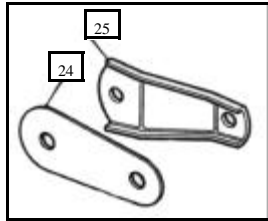
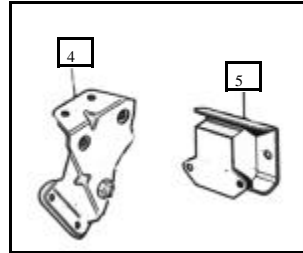
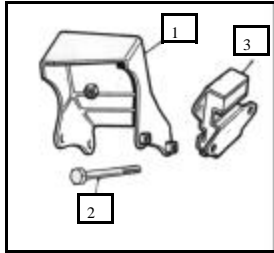

1.	12A361	Bracket – for Engine Mount – Frt. – (Reconditioned only) ----	1
2.	MM924	Bolt – Bracket to Transmission ----	2
3.	21A1902	Engine Mount – Front & Rear ----	2
4.	22A1274	Bracket – for Engine Mount – Automatic Trans-----	1
5.	22A917	Engine Mount – Front – Automatic Trans-----	1
5.	22A1018	Engine Mount – Rear – Automatic Trans-----	1
13.	21A1109	Engine Stabilizer Bar – Engine to Bulkhead -----	1
14.	2A5875	Stabilizer Bar Bush – Rubber-----	4
14.	MM284	Stabilizer Bar Bush – Polyurathane -----	4
14.	MM253	Stabilizer Bar Bush – Nylon – Racing-----	4
15.	MM258	Stabilizer Bar Bush Kit – Replaces #14 & 16-----	2
16.	31G1085	Distance Piece---	2
17.	ALA6505	Stabilizer Bar Mount Plate-----	1
18.	MM856	Bolt – Stabilizer Bar to Firewall Bracket-----	1
21.	606171	Bolt – Stabilizer Bracket through Bushings -----	1
22.	HZS505	Bolt – Stabilizer Bracket to Cyl. Head-----	1
23.	21A2387	Stabilizer Bracket – 998cc -----	1
24.	2A5869	Stabilizer Bracket – 850cc -----	1
25.	21A1107	Packing Piece – 850cc – NLA -----	1
42.	21A745	Bracket – Remote Trans. Housing – to ‘74 only -----	1
43.	ZHM1025	Mount – Remote Housing – Rubber-----	1
48.	21A2787	Stabilizer Bar – Lower L/H – ‘76 on – Angled 45° -----	1
49.	21A2785	Bar Bracket – for 21A2787 -----	1
50.	FAM2758	Stabilizer Bar – Lower R/H – ‘76 on – Straight -----	1
51.	NAM3760	Bar Bracket – for FAM2758-----	1
52.	MM284	Stabilizer Bushing (poly.) -----	4
52.	2A5875	Stabilizer Bushing (rubber)-----	4
53.	MM854	Bolt – Lower Stabilizer Bar-----	1
54.	MM847	Nut – Nylock – for MM854-----	1
55.	MM678	Engine Stabilizer Adjustable (not shown) -----	1
55.	MM426	Engine Stabilizer Kit – Hvy Duty – 998cc -----	1
55.	MM427	Engine Stabilizer Kit – Hvy Duty – 1275cc -----	1

NOTE: All bushings for the Top Engine Stabilizer Bar also fit all lower ones.

TRANSMISSION TYPES BY YEAR

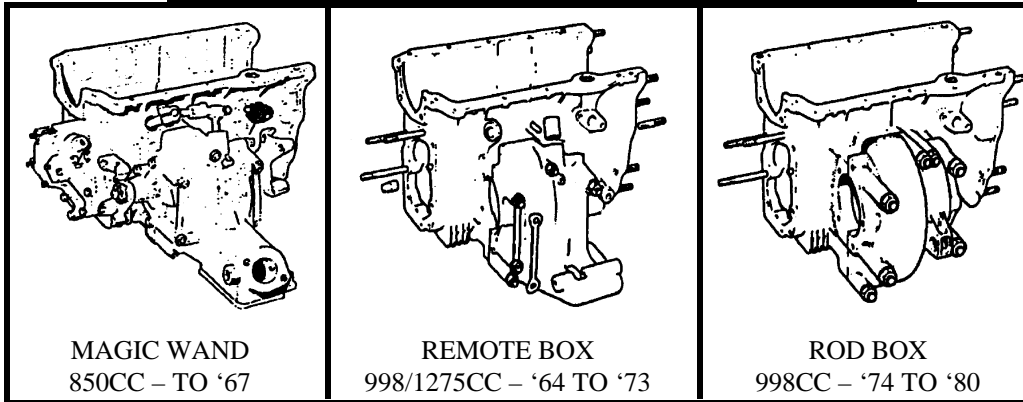

TRANSMISSION

Qty. Req'd.

- 1. CAM6548 Main Bearing Cap Oil Seal – Half Moon -----1
- 2. GEG502 Gasket – Transmission to Block – 2 pcs. – O/E-----1
- 2. MM434 Gasket – Transmission to Block – 2 pcs. – Aftermrkt -----1
- 3. 38G567 Transmission Assembly – Reco – Rod Type Gear
Change – '74 on -----1
- 7. 18G8085 Locktab Set – Transmission – 19 pcs. -----1
- 8. 2A3505 Gasket – Diff Housing – Upper – Remote Box-----1
- 9. 2A3506 Gasket – Diff Housing – Lower – Remote Box -----1
- 8. 2A3505 Gasket – Diff Housing – Upper – Rod Box -----1
- 10. 22G1836 Gasket – Diff Housing – Lower – Rod Box -----1
- 20. 88G302 Idler Gear Bearing – 3 Synchro Remote Box-----1
- 20. 13H7848 Idler Gear Bearing – 4 Synchro – '69 to '79 -----1
- 20. AHU1707 Idler Gear Bearing – 4 Synchro – Late '79-'80-----1
- 21. 51K3565 Circlip – Idler Gear Bearing-----1
- 23. 88G207 Front Cover – Trans Case (used only) -----1
- 24. 22A541 Gasket – Front Cover -----1
- 25. 2A3626 Front Cover Plate -----1
- 26. 2A3627 Gasket – Front Cover Plate -----1
- 27. 22A335 Oil Strainer (used only) -----1
- 28. 22A341 'O' Ring Seal – Suction Pipe to Strainer-----1
- 29. 22G1150 Oil Suction Pipe (used only) -----1
- 30. 22A542 Gasket – Pipe to Trans Case-----1
- 31. MM359 Oil Pick-up Pipe – Competition-----1
- 34. 2A3637 Blank Plate – Suction Pipe (usedf only) -----1
- 35. 22A542 Gasket – Blank Plate-----1
- 37. TRS1317 'O' Ring – Trans Face – Suction Drilling -----1
- 38. 88G210 Oil Drain Plug – Magnetic-----1
- 39. AED172 Washer – Copper -----1
- 40. 13H6862 Seal – Rod Shift Entry to Box -----1
- 41. DAM3022 Gaiter – Rod Shift – Rubber -----1
- 43. MM385 Gasket Set – Transmission – Rod Box-----1
- 43. MM386 Gasket Set – Transmission – Remote Box -----1
- 44. DAM7086 Rod Shift Sleeve -----1
- 45. CDU1563 'O' Ring Sleeve - -----1
- 46. MM776 Rod Shift Seal Modification Kit (includes 40,41,44,45) -----1

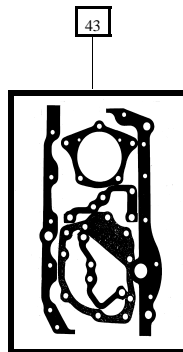
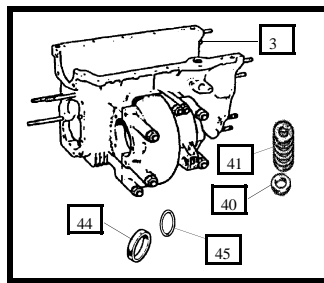
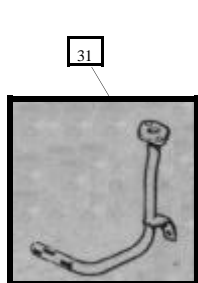
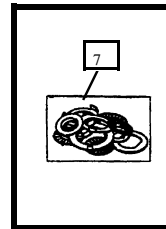
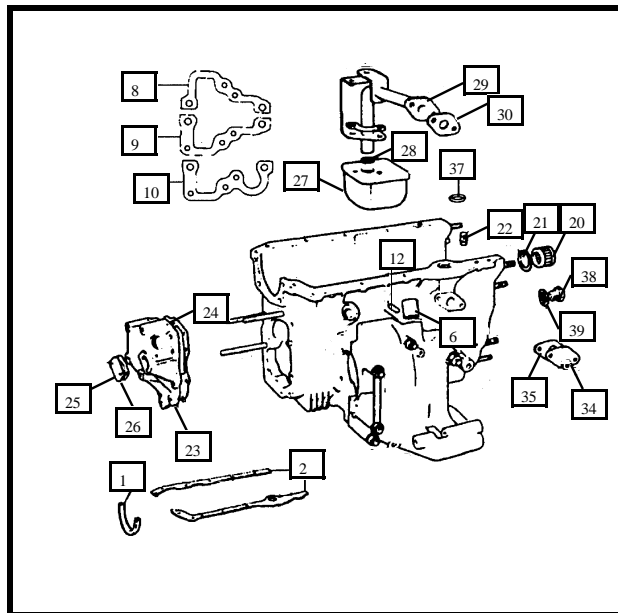

TRANMISSION CONT'D

Qty. Req'd.

TRANS TYPES – 850cc Magic Wand to '67 – 998/1275cc Remote to '74

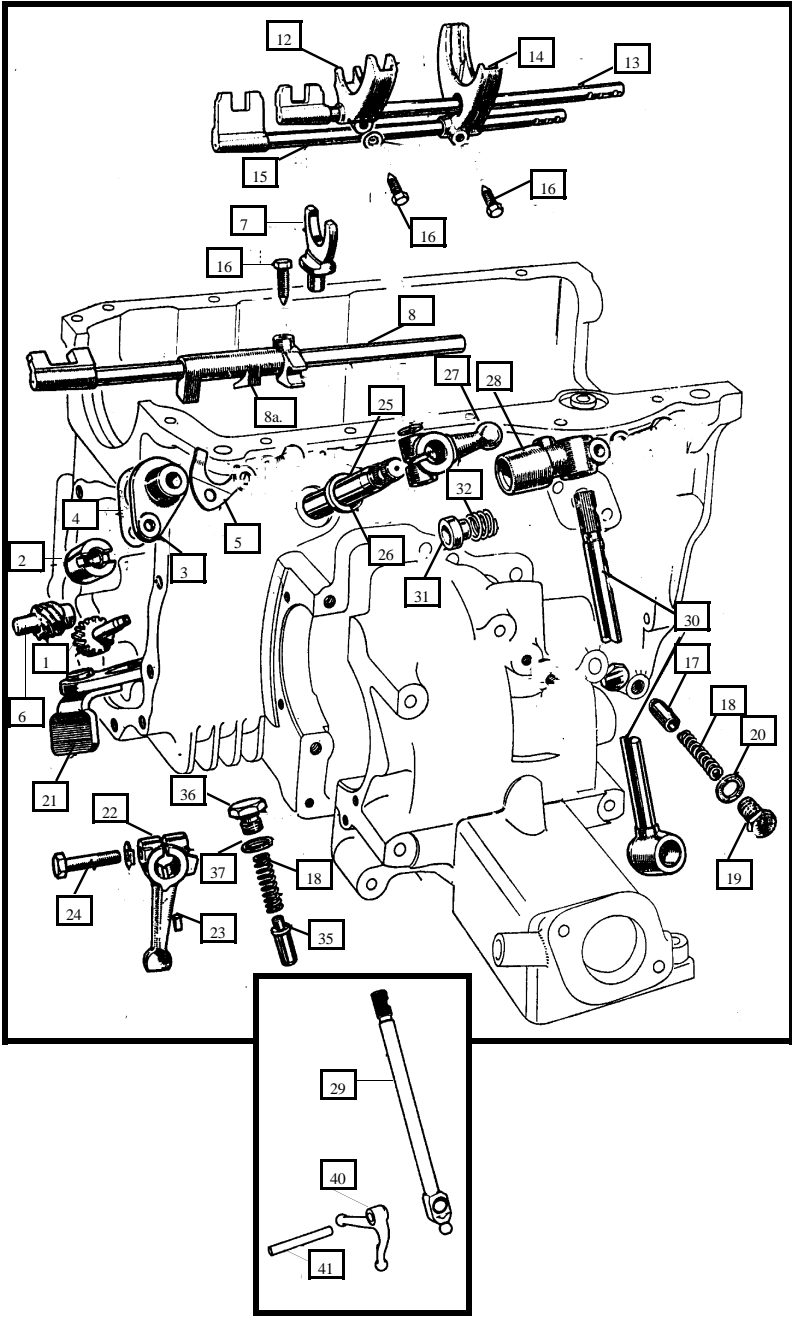

- 1. 22A1881 Speedo Pinion Gear – Nylon – 17 Teeth -----1
- 1. TXD10004 Speedo Pinion Gear -----1
- 1. TXD10006 Speedo Pinion Gear – Nylon – 18 Teeth -----1
- 2. 2A3624 Bush – Metal Seating -----1
- 3. 28G251 Housing with Seal -----1
- NKC105 Speedo Pinion Housing w/ Seal (not shown) -----1
- 4. 2A3628 Gasket – Housing -----1
- 5. 22A862 Clamp Plate – Hold Down -----1
- 6. 2A3720 Speed Drive Gear – 6 Teeth -----1
- 7. 22G827 Reverse Fork – NLA -----1
- 8. 22A169 Reverse Selector Rod -----1
- 8a. 88G213 Selector – Reverse Rod -----1
- 11. CCN108 Circlip – Lever to Pivot Pin -----1
- 12. 22A611 Selector Fork – 1st & 2nd – 3 Synchro Trans -----1
- 12. 22G889 Selector Fork – 1st & 2nd – 4 Synchro Trans -----1
- 13. 22A167 Selector Rod – 1st & 2nd – 3 Synchro Trans -----1
- 13. 22G821 Selector Rod – 1st & 2nd – 4 Synchro Trans -----1
- 14. 22A610 Selector Fork – 3rd & 4th – 3 & 4 Synchro Trans -----1
- 15. 22A168 Selector Rod – 3rd & 4th – 3 Synchro Trans -----1
- 15. 22G822 Selector Rod – 3rd & 4th – 4 Synchro Trans -----1
- 16. 2A4392 Bolt – Fork & Rod Locating -----1
- 17. 22G411 Detent Plunger – Fork/Rod -----1
- 18. 2A3647 Spring – Plunger -----1
- 19. 22A387 Plug – Cap -----1
- 20. AED172 Washer – Copper -----1
- 21. 22A208 Change Speed Gate -----1
- 22. 88G222 Change Speed Lever -----1
- 23. WKN404 Key – Change Speed Lever -----1
- 24. 2A3335 Bolt – Lever Securing -----1
- 25. 88G231 Gear Change Shaft -----1
- 26. 13H577 Oil Seal – Gear Change Shaft -----1
- 27. 88G224 Gear Change Knuckle – Male -----1
- 28. 88G223 Gear Change Knuckle – Female -----1
- 29. 22A253 Remote Change Shaft -----1
- 30. 88G553 Change Shaft – 850cc – Magic Wand Box -----1
- 31. 2A3467 Gear Lever Thrust Button – Magic Wand Box -----1
- 32. 2A3390 Spring – for Thrust Button – Magic Wand Box -----1
- 35. 22A191 Detent Plunger – Reverse -----1
- 36. 22A149 Plug – Cap – Detent Plunger -----1
- 37. AED172 Washer – Copper -----1
- 40. 22G79 Lever – Bell Crank – Remote Box -----1
- 41. 22G259 Pivot Pin – Remote Box -----1

TRANMISSION CONT'D

Qty. Req'd.

TRANS TYPES – 850cc Magic Wand to '67 – 998/1275cc Remote to '74

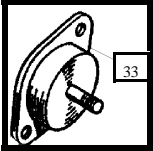
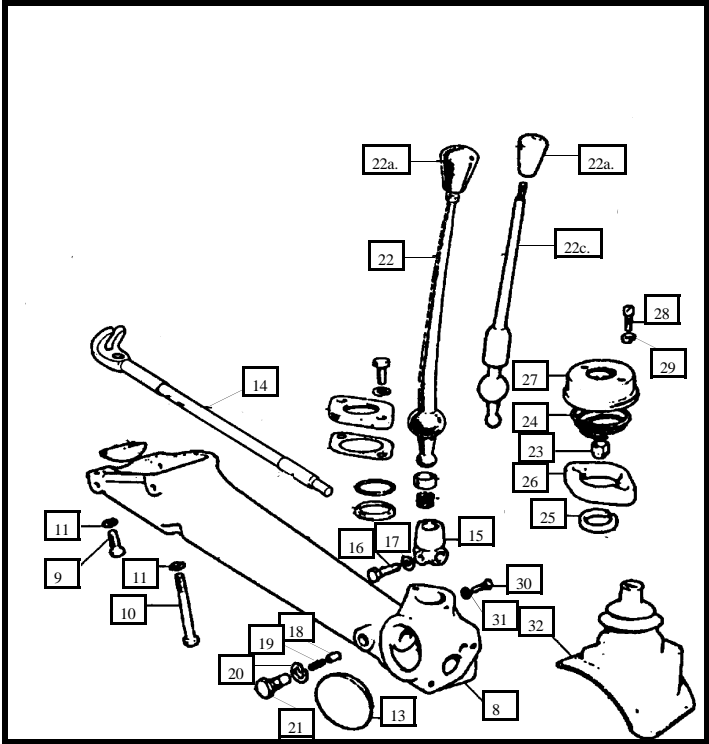
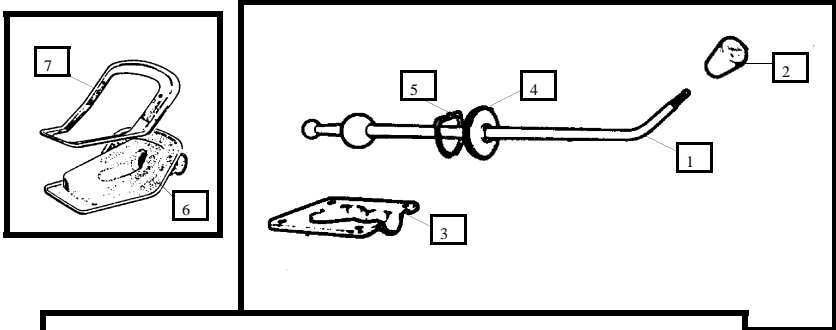

1.	22A1382	Gear Shift Lever – 850cc-----	1
2.	22G110	Gear Shift Knob – OBSOLETE – 850cc -----	1
2.	MM256	Gear Shift Knob – Alternative – Leather-----	1
2.	MM257	Gear Shift Knob – Alternative – Wood-----	1
3.	22A1717	Cover Plate – Gear Lever – 850cc -	1
4.	22A1380	Gaiter – Shift Lever – Rubber – Early – 850cc-----	1
5.	22A1381	Gaiter Retaining Ring – Early – 850cc -----	1
6.	14A6860	Gaiter – Shift lever – Rubber – 850cc -----	1
7.	14A6861	Gaiter Retaining Ring – 850cc-----	1
8.	22A250	Remote Shift Housing-----	1
9.	GHF165	Bolt – Remote Housing – Short ----	2
10.	ZCS628	Bolt – Remote Housing – Long ----	2
11.	MM874	Washer – Spring -----	4
12.	22A285	Dust Plug – Rubber – Half Moon --	1
13.	22A271	Dust Plug – Rubber – Round -----	1
14.	8G713	Gear Selection Shaft -----	1
15.	22A267	Knuckle – Female – Gear Shift Lever -----	1
16.	2A3335	Bolt – Knuckle to Shaft-----	1
17.	MM824	Washer – Spring -----	1
18.	22A84	Plunger – Anti-Rattle -----	1
19.	AEG2123	Spring – Anti-Rattle -----	1
20.	AEG3122	Washer – Spring -----	1
21.	22A85	Cap – Spring Retainer -----	1
22.	22A1586	Gear Shift Lever – Black -----	1
22c.	22G1190	Gear Shift Lever – Cooper – Chrome-----	1
22a.	22G1652	Gear Shift Knob – Use MM256 or MM257 -----	1
23.	22G389	Seating Bush – Lever Ball – Split Nylon-----	1
24.	22G286	Tension Spring--	1
25.	22G292	Flange – Nylon--	1
26.	88G228	Distance Piece---	1
27.	22G290	Gear Lever Retaining Cap -----	1
28.	22G291	Bolt – Retaining Cap-----	1
29.	MM824	Washer – Spring -----	1
30.	2A3602	Locating Pin – Slot in Gear Lever -	1
31.	MM811	Washer – Spring -----	1
32.	22A608	Gaiter – Gear Shift Lever – Rubber -----	1
33.	ZHM1025	Mount – Remote Housing Rear Support-----	1
34.	21A745	Remote Housin Bracket (not shown) -----	1

TRANSMISSION CONT'D

Qty. Req'd.

TRANS TYPE – Remote Box '68 to '74 – Rod Box '74 to '79

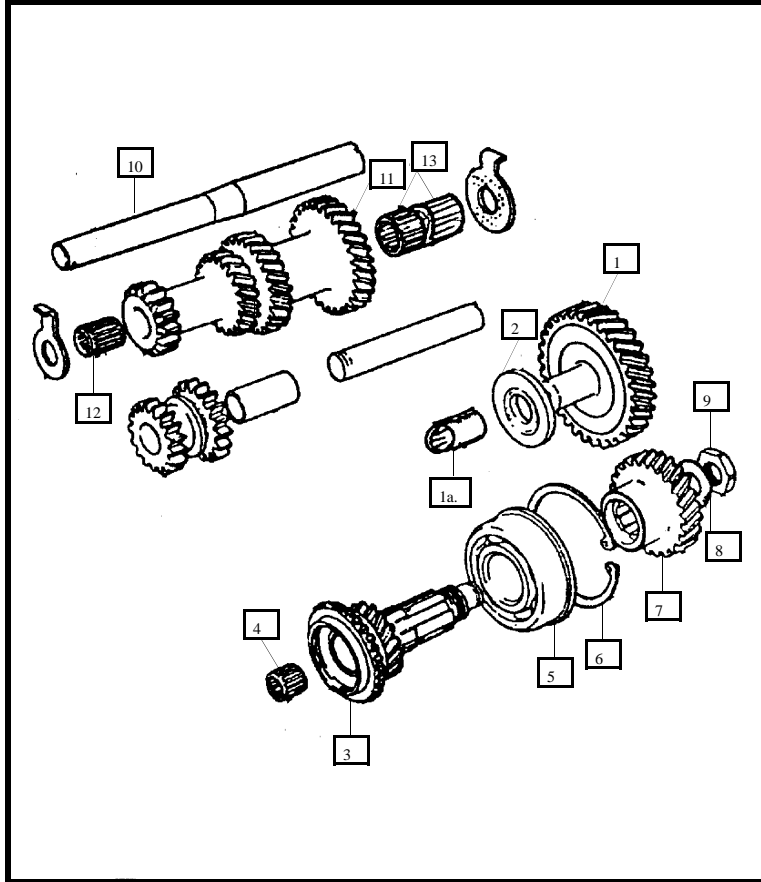

- | | | | |
|------|---------|--|---|
| 1. | 22G943 | Idler Gear – 31 Teeth ----- | 1 |
| 1a. | 13H7848 | Idler Gear Bearing----- | 1 |
| 2. | 22A1544 | Idler Gear Thrust Washer – .130”-.131” Remote Box ----- | 1 |
| 2. | 22A1545 | Idler Gear Thrust Washer – .132”-.133” Remote Box ----- | 1 |
| 2. | 22A1547 | Idler Gear Thrust Washer – .134”-.135” Remote Box ----- | 1 |
| 2. | 22A1548 | Idler Gear Thrust Washer – .136”-.137” Remote Box ----- | 1 |
| 2. | 22A1549 | Idler Gear Thrust Washer – .138”-.139” Remote Box ----- | 1 |
| 2. | DAM2695 | Idler Gear Thrust Washer – .132”-.133” Rod Box ----- | 1 |
| 2. | DAM2696 | Idler Gear Thrust Washer – .134”-.135” Rod Box ----- | 1 |
| 2. | DAM2697 | Idler Gear Thrust Washer – .136”-.137” Rod Box ----- | 1 |
| 2. | DAM2698 | Idler Gear Thrust Washer – .138”-.139” Rod Box ----- | 1 |
| 3. | 22G325 | 1st Motion Shaft – 850/998cc – 19 Teeth Remote Box ----- | 1 |
| 3. | 22G1093 | 1st Motion Shaft – 998cc – 17 Teeth Remote Box ----- | 1 |
| 3. | 22G1371 | 1st Motion Shaft – 1275cc – 18 Teeth Remote Box ----- | 1 |
| 3. | DAM3092 | 1st Motion Shaft – 998cc – 17 Teeth Rod Box ----- | 1 |
| 4. | CHM172 | Bearing – 1st Motion Shaft – Inner Caged ----- | 1 |
| 5. | ADU7619 | Bearing – 1st Motion Shaft – Large Roller ----- | 1 |
| 6. | 22G850 | Circlip – Bearing Retainer – .098” Thick----- | 1 |
| 6. | 22G851 | Circlip – Bearing Retainer – .104” Thick----- | 1 |
| 7. | 22G849 | 1st Motion Gear – 24 Teeth----- | 1 |
| 8. | 22A612 | Locktab ----- | 1 |
| 9. | 2A3548 | Nut – Gear Retaining ----- | 1 |
| 10. | 22A1731 | Layshaft – Comp – 3 Synchro----- | 1 |
| 10. | 22A1738 | Layshaft – Comp – 4 Synchro----- | 1 |
| 10. | 22G931 | Layshaft – Std. -- ----- | 1 |
| 11. | 22G927 | Laygear – 850 & 998cc----- | 1 |
| 11. | 22G1040 | Laygear – 1275cc----- | 1 |
| 12. | 88G396 | Bearing – Inner Caged----- | 1 |
| 12a. | 22G278 | Circlip for 88G396 ----- | 1 |
| 13. | CHM141 | Bearing – Inner Caged – 2 Req’d----- | 2 |

TRANSMISSION CONT'D

Qty. Req'd.

TRANS TYPE – Remote Box '68 to '74 – Rod Box '74 to '79

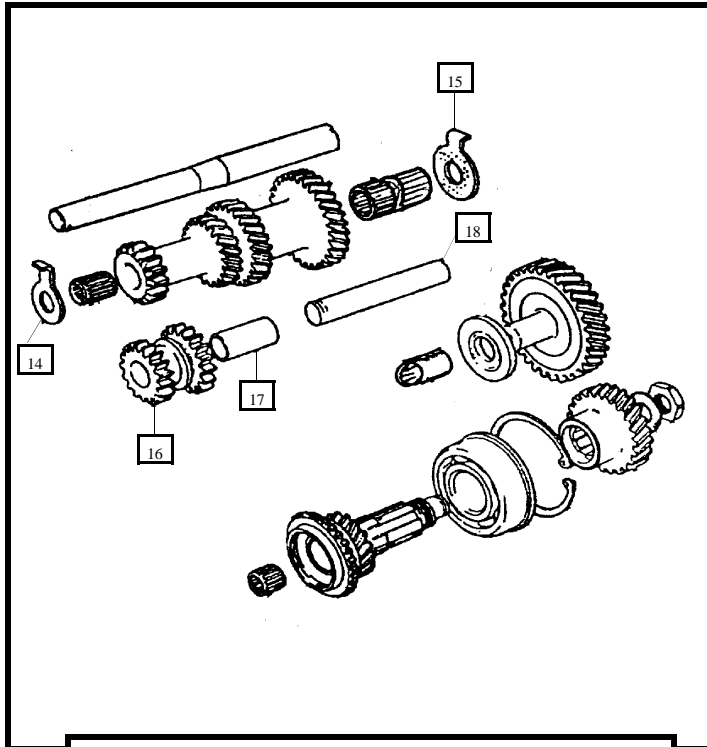

- | | | | |
|-----|---------|---|---|
| 14. | 22G856 | Laygear Thrust Washer – .123”-.124”----- | 1 |
| 14. | 22G857 | Laygear Thrust Washer – .125”-.126”----- | 1 |
| 14. | 22G858 | Laygear Thrust Washer – .127”-.128”----- | 1 |
| 14. | 22G859 | Laygear Thrust Washer – .130”-.131”----- | 1 |
| 15. | 22G860 | Laygear Thrust Washer – Large Diameter----- | 1 |
| 16. | 22G1034 | Reverse Idler Gear – Remote Box - ----- | 1 |
| 16. | 22G1852 | Reverse Idler Gear – Rod Box----- | 1 |
| 17. | 22G825 | Bush – Reverse Idler Gear ----- | 1 |
| 18. | DAM8038 | Shaft – Reverse Idler Gear----- | 1 |

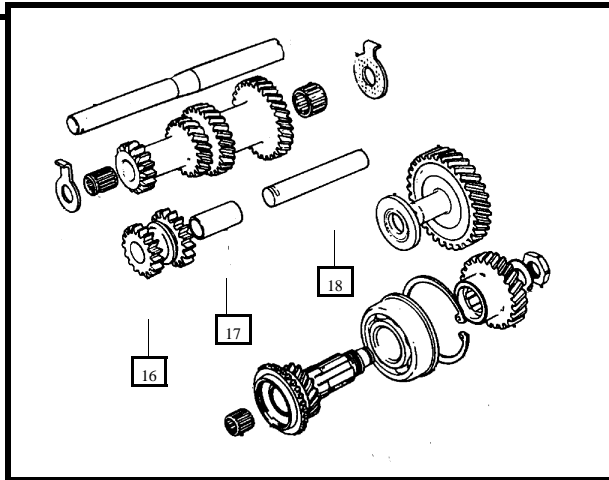

TRANSMISSION CONT'D

Qty. Req'd.

TRANS TYPE – Remote Box '68 to '74 – Rod Box '74 to '79

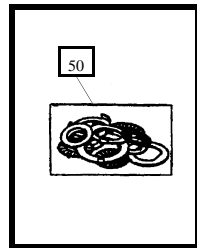
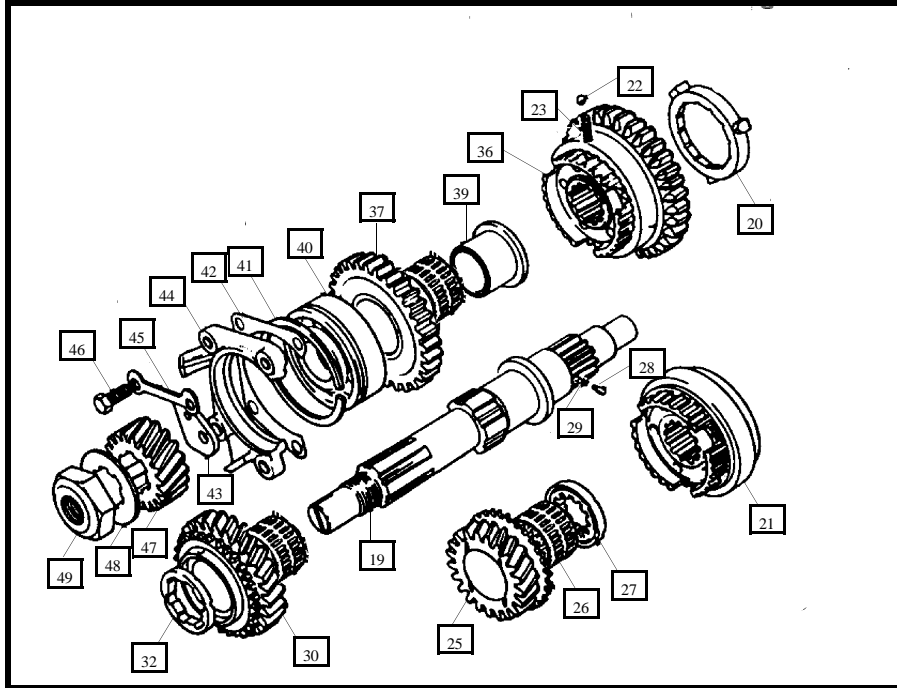

19.	22G833	3rd Motion Shaft -----	1
20.	22G2033	Baulk Ring -----	4
21.	22G2264	3rd & 4th Speed Synchronizer Hub -----	1
22.	BLS107	Ball Bearing – (3 per Hub) -----	6
23.	22G2262	Spring – (3 per Hub) -----	6
25.	22G1095	3rd Speed Gear – 21 Teeth -----	1
26.	88G496	Bearing – Inner Caged Roller -----	1
27.	22G947	Thrust Washer ---	1
28.	22G843	Peg -----	3
29.	22G154	Spring -- -----	2
30.	22G1094	2nd Speed Gear – 26 Teeth -----	1
31.	88G496	Bearing – Inner Caged Roller -----	1
32.	22G839	Thrust Washer ---	1
36.	22G2263	1st & 2nd Speed Synchronizer Hub -----	1
37.	22G1096	1st Speed Gear – 31 Teeth -----	1
38.	AAU1815	Bearing – Inner Caged Roller -----	1
39.	22G837	1st Speed Gear Journal -----	1
40.	22G1005	3rd Motion Shaft Bearing – Large Roller -----	1
41.	22G72	Spring Ring -----	1
42.	2A3714	Shim – 2 Thou -- -----	1
42.	2A3715	Shim – 10 Thou- -----	1
43.	2A3581	Locating Plate ---	1
44.	22A522	Bearing Retainer – Remote Box ---	1
44.	22G2726	Bearing Retainer – Rod Box -----	1
45.	DAM2377	Locktab – Retainer -----	2
46.	SH505071	Bolt for Retainer -----	4
47.	22A399	Final Drive Pinion – 17 Teeth – 3.76:1 ratio -----	1
47.	22A413	Final Drive Pinion – 18 Teeth – 3.44:1 ratio -----	1
48.	22A613	Locktab – Final Drive Pinion -----	1
49.	22G48	Nut – Pinion Retaining -----	1
50.	18G8085	Locktab Set – Transmission – 19 Pieces -----	1

TRANSMISSION CONT'D

Qty. Req'd.

TRANS TYPE – Rod Shift Box – '74 to '80

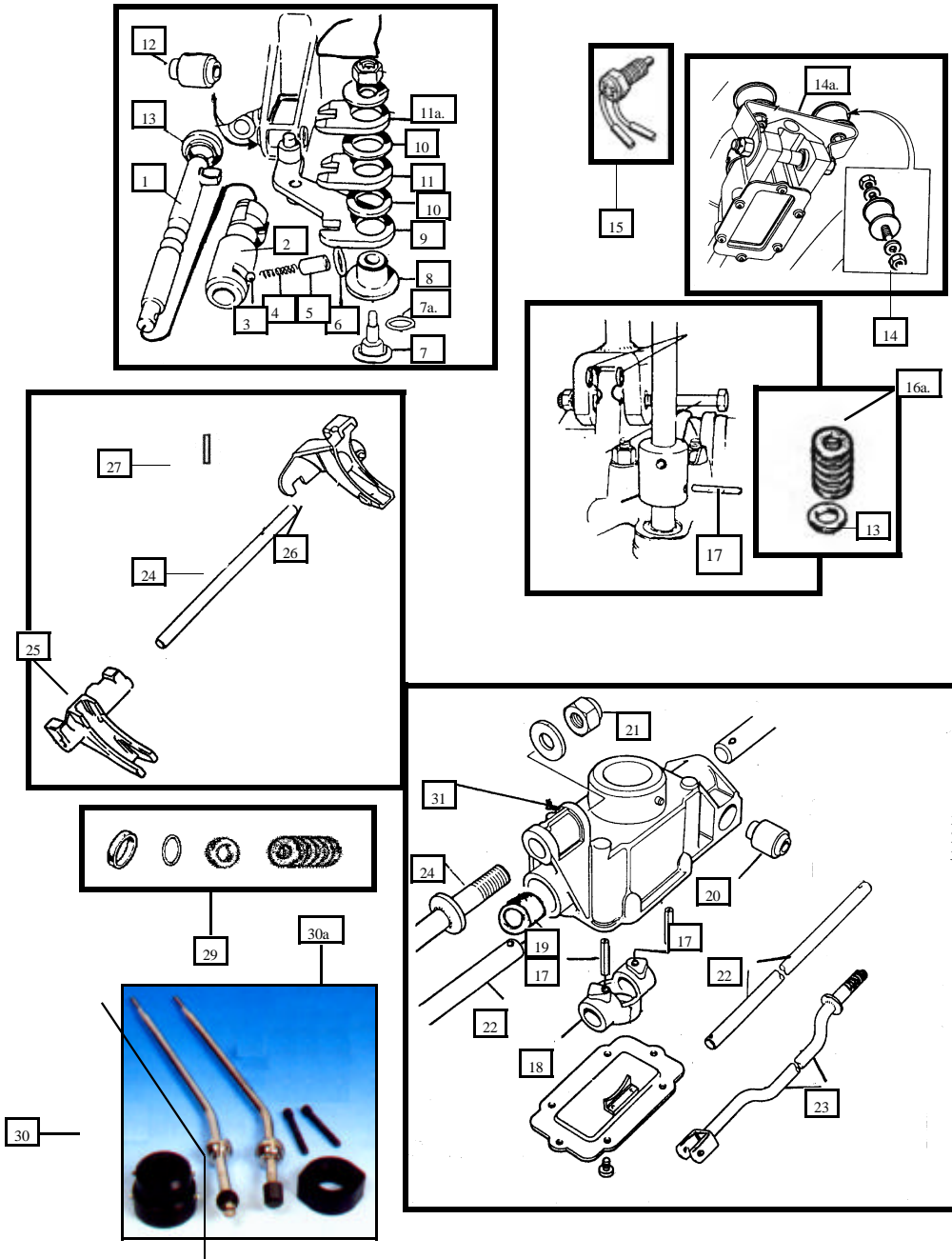

1.	22G1858	Selector Shaft-----	1
2.	22G1844	Interlock Spool-- -----	1
3.	BLS110	Ball Bearing – for Detent -----	1
4.	22G2083	Spring – for Detent -----	1
5.	22G1870	Detent Sleeve -----	1
6.	22G1417	'O' Ring for Sleeve -----	1
7.	22G1845	Bell Crank Pivot Pin -----	1
7a.	31B447	'O' Ring for Pivot Pin -----	1
8.	42H1077	Pivot Bush-----	1
9.	22G1849	Release Lever – Reverse-----	1
10.	42H1081	Spacer – Release Lever -----	1
11.	22G1847	Bell Crank Lever – Lower -----	1
11a.	22G1848	Bell Crank Lever – Upper-----	1
12.	13H7286	Metalastick Bush – Transmission Case Fitting -----	1
13.	13H6862	Oil Seal – Selector Shaft -----	1
14.	22G2205	Mount – Selector Rods Housing – Rubber -----	2
14a.	22G2026	Rod Shift Support Bracket -----	1
15.	GAE133	Reverse Light Switch -----	1
16.	42H1116	Coupling – Selector Rod -----	1
16a.	DAM3022	Gaiter – Selector Rod – Rubber -----	1
17.	MM368	Roll Pin for Coupling -----	2
18.	22G2792	Eye – Selector Rod – (Inside Housing) -----	1
19.	MM369	Bush – Brass-----	2
20.	42H1214	Metalastick Bush – (Rear of Housing)-----	2
21.	MM876	Nut – for Steady Shaft -----	1
22.	22G1930	Selector Rod -----	1
23.	ADU4402	Steady Shaft -----	1
24.	22G1854	Selector Shaft – for Forks (Inside Trans)-----	1
25.	22G1855	1st & 2nd Speed Selector Fork (Inside Trans) -----	1
26.	22G1856	3rd & 4th Speed Selector Fork (Inside Trans) -----	1
27.	22G2595	Roll Pin 3rd & 4th Fork -----	1
29.	MM776	Rod Shift Modification Kit(4 pce.–Gaiter,Seal,Sleeve,O Ring) 1	
30.	22A1751	Quick Change Kit – Rod -----	1
30a.	22A1750	Quick Change Kit – Remote-----	1
31.	MM935	Rod Shift Mechanism – Complete – Reco.-----	1
32.	42H1199	Rod Eye Support Shaft -----	1

TRANSMISSION CONT'D

Qty. Req'd.

TRANS TYPE – Rod Shift – '79 to '80

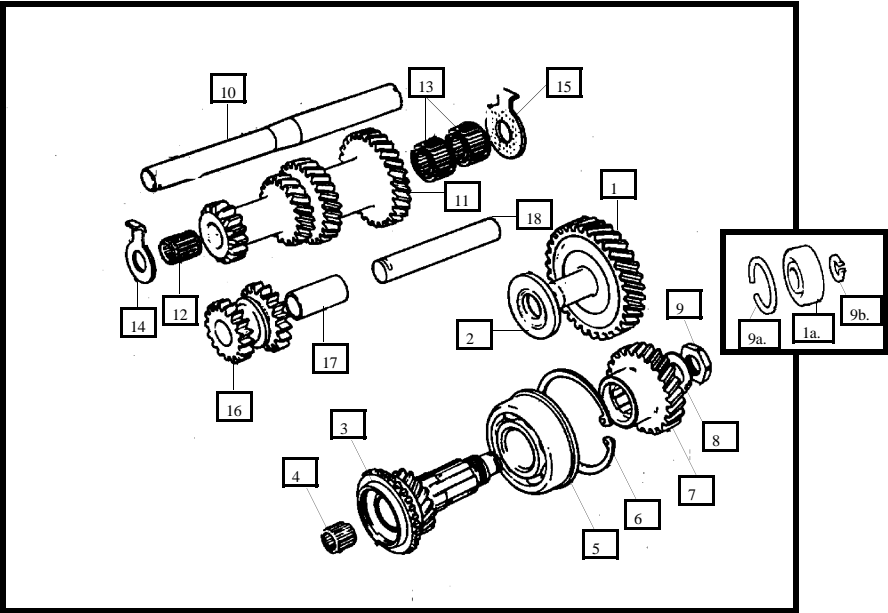

- 1. DAM2924 Idler Gear ----- 1
- 1a. AHU1707 Idler Gear Bearing----- 1
- 1b. DAM3745 Idler Gear Bearing & Sleeve – Interim '79 only----- 1
- 2. DAM5914 Idler Gear Thrust Washer – .130”-.131” ----- 1
- 2. DAM4822 Idler Gear Thrust Washer – .132”-.133” ----- 1
- 2. DAM4823 Idler Gear Thrust Washer – .134”-.135” ----- 1
- 2. DAM4824 Idler Gear Thrust Washer – .136”-.137” ----- 1
- 2. DAM4825 Idler Gear Thrust Washer – .138”-.139” ----- 1

- 3. DAM3092 1st Motion Shaft ----- 1
- 4. 13H9513 Bearing – 1st Motion Shaft – Inner Caged ----- 1
- 5. ADU7619 Bearing – 1st Motion Shaft – Ball Bearing (Large)----- 1
- 6. 22G850 Bearing Circlip – .098” Thick ----- 1
- 6. 22G851 Bearing Circlip – .104” Thick ----- 1
- 7. DAM2925 1st Motion Gear – 29 Teeth----- 1
- 8. DAM4000 Locktab ----- 1
- 9. 2A3548 Nut – Retaining - ----- 1
- 9a. 2A3643 Circlip – Clutch Housing----- 1
- 9b. CCN110 Circlip – 1st Motion Shaft ----- 1

- 10. DAM3187 Layshaft – 3 Step Type ----- 1
- 11. DAM3169 Laygear – 998cc ----- 1
- 11. DAM3168 Laygear – 1275cc – OBSOLETE -- ----- 1
- 12. 13H9513 Bearing – Laygear – Inner Caged - ----- 1
- 13. CHM141 Bearing – Laygear – Inner Caged – 2 Req'd ----- 2
- 14. DAM3180 Laygear Thrust Washer – .121”-.123” - Small----- 1
- 14. DAM3181 Laygear Thrust Washer – .124”-.126” - Small----- 1
- 14. DAM3182 Laygear Thrust Washer – .127”-.129” - Small----- 1
- 14. DAM3183 Laygear Thrust Washer – .130”-.132” - Small----- 1
- 15. 22G860 Laygear Thrust Washer – Large --- ----- 1
- 16. TUB10020 Reverse Gear----- 1
- 17. 22G825 Bush – Reverse Gear ----- 1
- 18. DAM8038 Shaft – Reverse Gear----- 1

TRANSMISSION CONT'D

Qty. Req'd.

TRANS TYPE – Rod Shift – '79 to '80

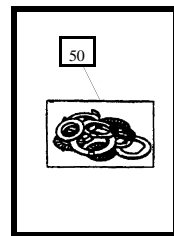
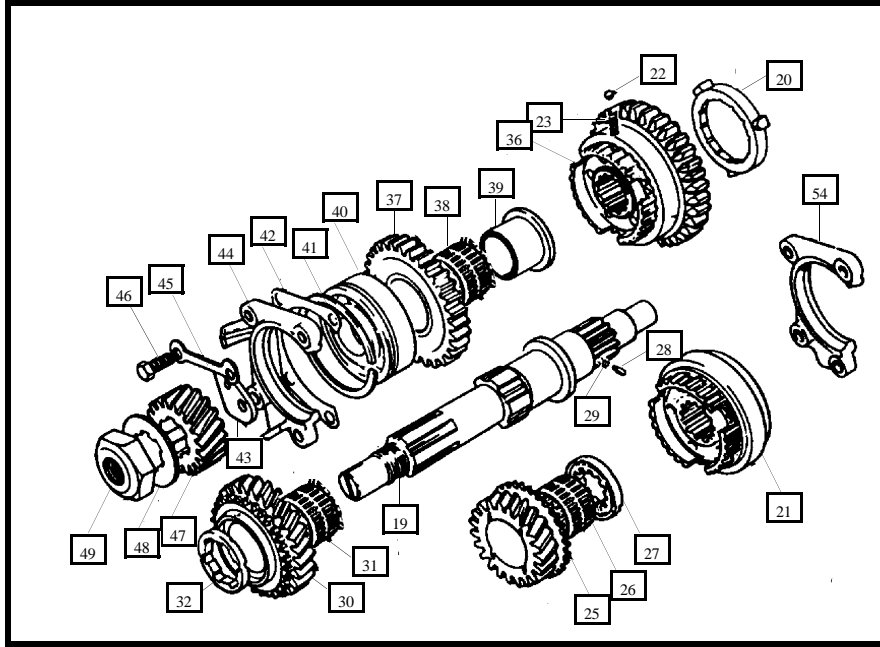

19.	DAM7484	3rd Motion Shaft -----	1
20.	22G2033	Baulk Ring-----	4
21.	DAM7456	3rd & 4th Synchronizer Hub -----	1
22.	BLS107	Ball – for Synchro Hub – 3 per Hub-----	6
23.	22G2262	Spring – for Synchro Hub – 3 per Hub -----	6
25.	DAM4933	3rd Gear – 21 Teeth-----	1
26.	88G496	Bearing – Inner Caged-----	1
27.	22G947	Thrust Washer---	1
28.	22G843	Peg – 2nd & 3rd Gear-----	1
29.	22G154	Spring – for Peg- -----	1
30.	DAM4932	2nd Gear – 26 Teeth -----	1
31.	88G496	Bearing – Innder Caged -----	1
32.	22G839	Thrust Washer---	1
36.	DAM7456	1st & 2nd Synchronizer Hub -----	1
37.	22G1096	1st Gear – 33 Teeth -----	1
38.	AAU1815	Bearing – Inner Caged-----	1
39.	22G837	Journal – 1st Gear -----	1
40.	AAU1365	Ball Bearing – 3rd Motion Shaft---	1
41.	22G72	Spring Clip-----	1
42.	2A3714	Shim – 2 Thou -- -----	1
42.	2A3715	Shim – 10 Thou- -----	1
43.	2A3581	Locating Plate --- -----	1
44.	DAM1756	Bearing Retainer – 4 Bolt Holes --- -----	1
45.	DAM2377	Locktab -----	1
46.	SH505271	Bolt – for Retainer-----	4
47.	DAM2679	Final Drive Pinion – 18 Teeth – 3.44:1 Ratio-----	1
47.	DAM5927	Final Drive Pinion – 20 Teeth – 2.95:1 Ratio-----	1
48.	22A613	Locktab -----	1
49.	DAM7485	Pinion Nut -----	1
50.	18G8085	Locktab Set – Transmission – 19 Pieces -----	1

TRANSMISSION CONT'D

Qty. Req'd.

TRANS TYPE – Rod Shift – '74 to '80

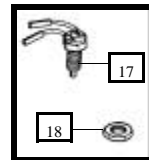
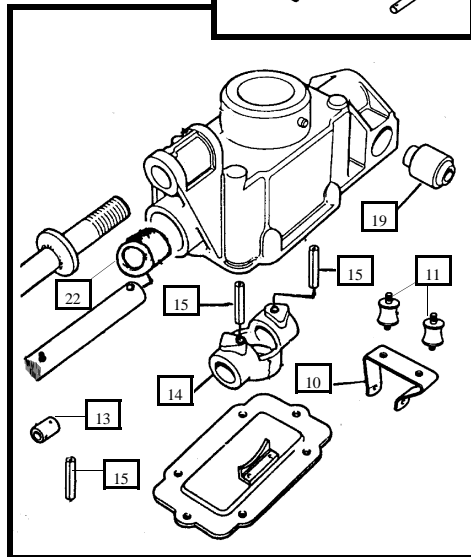
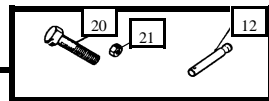
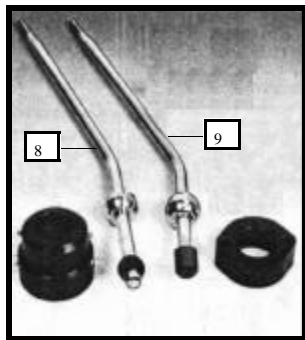
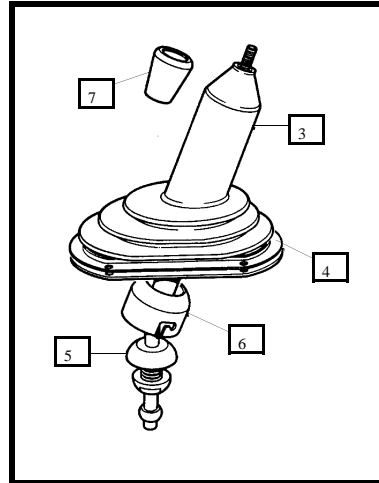
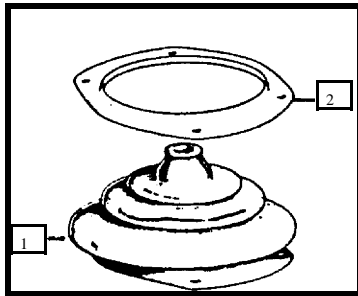

1.	22G294	Gaiter – Gear Shift Lever – '74 to '76-----	1
2.	ACA9711	Retainer for Gaiter-----	1
3.	CZH4278	Gaiter – Gear Shift Lever – '77 to '80-----	1
4.	CZH3002	Retainer for Gaiter-----	1
5.	22A1932	Gear Shift Lever -----	1
6.	22G1434	Spring Retainer Cap -----	1
7.	22G2316	Gear Knob – OBSOLETE – Use MM256-----	1
7.	MM256	Gear Knob – Leather – with Emblem – eg. Leyland-----	1
8.	22A1751	Quickshift Gear Change – Rod Box-----	1
9.	22A1750	Quickshift Gear Change – Remote Box -----	1
10.	22G2026	Support Bracket – for Gear Lever Housing -----	1
11.	22G2205	Rubber Mounting – Bracket to Floor-----	2
12.	22G2306	Support Rod – Rear Sliding – also Reverse Switch -----	1
13.	22G1930	Support Rod – Front Sliding-----	1
14.	22G2792	Rod Shift Eye-----	1
15.	MM368	Roll Pin – for Rod Shift Eye & Coupling -----	3
16.	42H1116	Coupling – Shift Rod to Trans -----	1
17.	GAE133	Reverse Light Switch -----	1
18.	22A1613	Locknut for Switch -----	1
19.	42H1214	Metalastick Bush – for Support Bracket-----	2
20.	MM862	Bolt – Support Bracket -----	1
21.	MM872	Nut-----	1
22.	MM369	Bush – for Support Rods -----	2

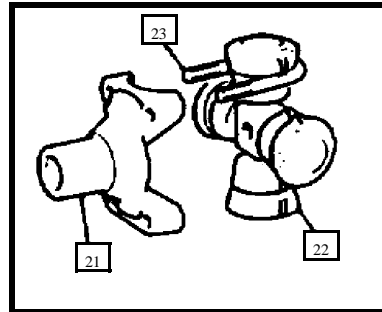
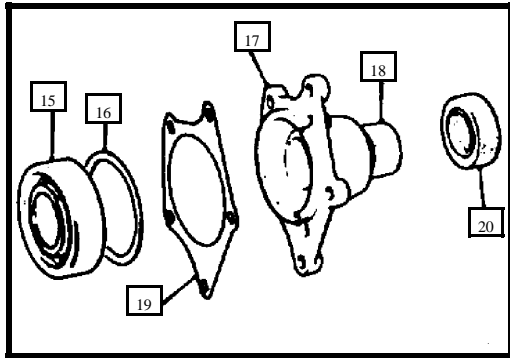
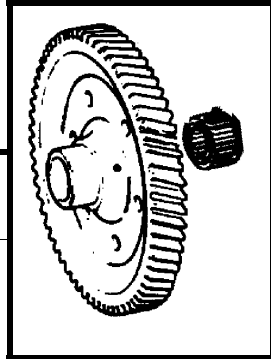
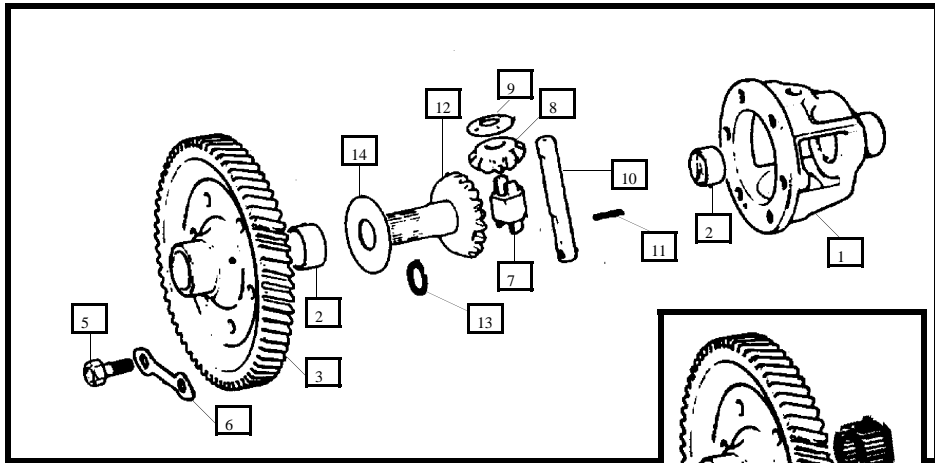

TRANSMISSION CONT'D

Qty. Req'd.

1.	DAM6027	Differential Cage Assembly-----	1
2.	ATA7378	Bush – Cage & Crownwheel -----	1
3.	22A411	Crownwheel Gear – 62 Teeth – 3.44:1 Ratio-----	1
3.	22G940	Crownwheel Gear – 62 Teeth – 3.65:1 Ratio-----	1
4.	MM431	Diff Set – Crownwheel & Pinion Gear – 2.95:1 Ratio-----	1
5.	ATA7232	Bolt – Crownwheel Gear to Cage--	1
6.	ATA7385	Locktab -----	3
7.	BTA154	Thrust Block-----	1
8.	2A7015	Spider Pinion ----	1
9.	2A7062	Thrust Washer – for Spider Pinion – Bronze-----	2
10.	22G2583	Pin – Pinion Centre -----	1
11.	RPS1418	Roll Pin – for Pin -----	1
12.	22A373	Output Shaft – Rubber Coupling U/J Type -----	2
12.	22A1151	Output Shaft – Steel Universals (Cooper ‘S’) -----	2
12.	22G1952	Output Shaft – Pot Joint U/J – ‘74 on-----	2
13.	22G2688	Circlip - -----	2
14.	BTA101	Thrust Washer – Fibre-----	2
15.	CHM110	Ball Bearing – Differential Support-----	2
16.	2A3535	Shim – for Bearing – .002” -----	2
16.	2A3534	Shim – for Bearing – .003” -----	2
17.	88G583	Side Cover – Rubber Coupling U/J Type – to ‘74 -----	2
17.	22G419	Side Cover – Steel Universals (Cooper ‘S’) -----	2
17.	CHM85	Side Cover – Pot Joint U/J – ‘74 on-----	2
18.	2A3538	Bush – Side Cover – Rubber Coupling & Pot Joint -----	2
18.	22G241	Bush – Side Cover – Cooper ‘S’ ---	2
19.	22A1611	Gasket – Side Cover-----	2
20.	22A1283	Oil Seal – Side Cover – Rubber Coup & Pot Joint -----	2
20.	AHU1082	Oil Seal – Side Cover – Cooper ‘S’ -----	2
21.	22A374	Diff Drive Flange – Rubber Coupling U/J’s -----	2
22.	GCD102	Drive Coupling Kit – Rubber UJ w/U Bolts & Nuts -----	2
22.	QL5000	Drive Coupling Kit-Nylon Replacement (GCD102) -----	2
23.	22A132	‘U’ Bolt only-----	4