

30

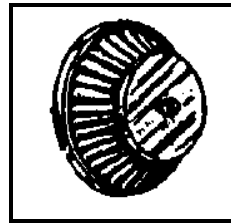

31



34

33



35

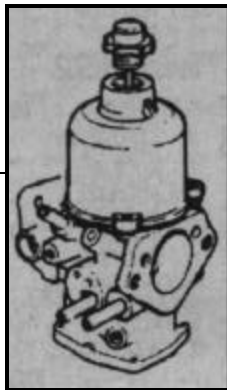

36

FILTER & PRESSURE REGULATORS

Qty. Req'd.

30.	MM489	Air Filter Chrome – K&N – 1 ¼" SU Carb -----	A/R
30.	MM477	Air Filter – K&N – 1 ½" SU Carb. -----	A/R
30.	MM478	Air Filter – K&N – 1 ¾" SU Carb. – -----	A/R
31.	MM473	Air Filter – K&N – 1 ¾" HIF Carb – Cone Shape ----	A/R
31.	MM486	Air Filter – K&N – 1 ½" SU Carb – Cone Shape -----	A/R
31.	MM667	Air Filter – K&N – 1 ¼" SU Carb – Cone Shape -----	A/R
31.	MM4732	Air Filter 1 ¾" SU Carb – Cone Shape-----	A/R
31.	MM4862	Air Filter 1 ½" SU Carb – Cone Shape-----	A/R
32.	88G549	Gasket – HIF Carb. (not shown) ---	A/R
33.	MM936	Insulator – HIF Carb. (not shown) -----	A/R
33.	MM796	Fuel Pressure Regulator-----	1
34.	MM1010	Fuel Filter – Chrome – Purolater-----	1
35.	MM673	K&N Air Filter – 45 Weber DCOE -----	1
	MM702	K&N Air Filter – 45 DCOE 4 ½" x 1 ¾" -----	A/R
	MM951	Main Jet – 185 – 45 DCOE-----	1
	MM961	Air Jet – 155 – 45 DCOE-----	1
36.	MM587	Rebuilt Carb – HIF44 – 1 1/2" -----	1
36.	MM588	Rebuilt Carb – HIF44 – 1 3/4" -----	1

EXHAUST SYSTEM

Qty. Req'd.

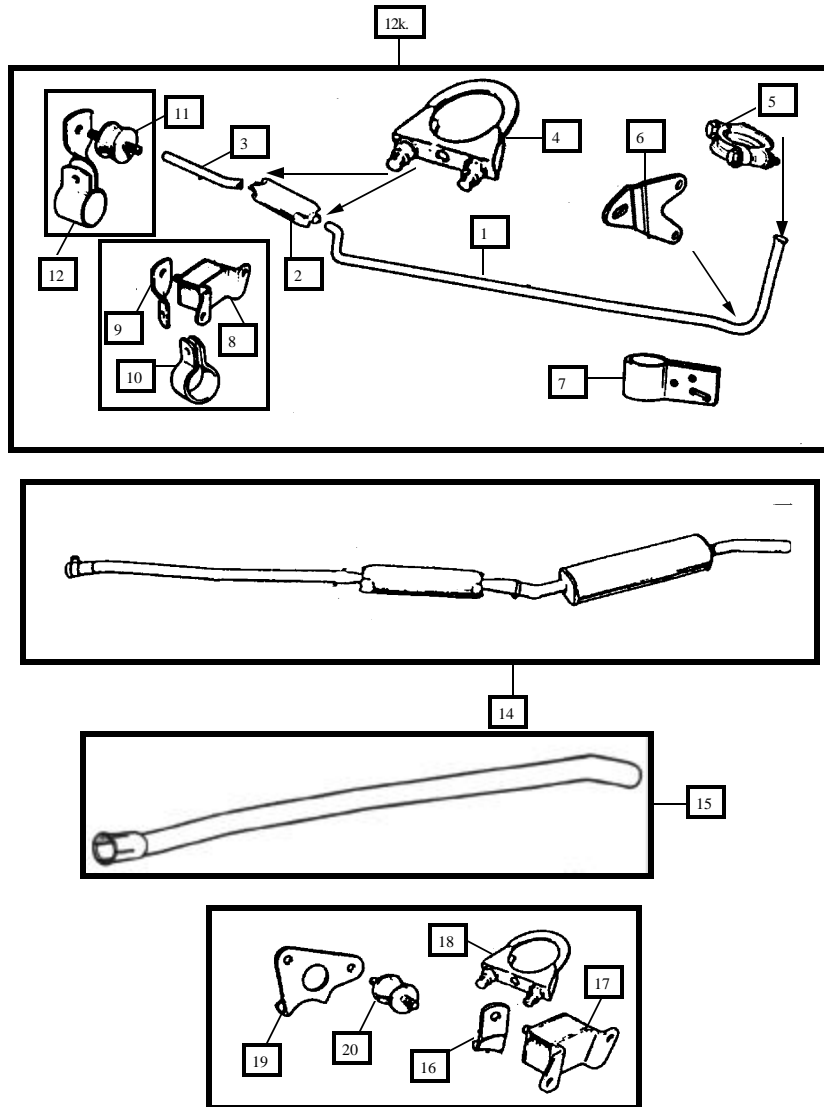

1.	GEX1285	Front Exhaust Pipe – Saloon – 998cc – ‘67 to ‘80	-----1
1.	21A18	Front Exhaust Pipe – Saloon – 850cc – to ‘67	-----1
2.	GEX3288	Muffler – All Models	-----1
3.	GEX1562	Tail Pipe – All Models	-----1
	GEX106	GEX1285, or 21A18, plus GEX3288 & GEX1562	-----1
4.	UPC3	Muffler Clamp – 1 3/8"	-----2
4.	MM009	Muffler Clamp – 1 5/8"	-----2
4.	MM010	Muffler Clamp – 1 3/4"	-----2
4.	MM011	Muffler Clamp – 1 7/8"	-----2
4.	MM012	Muffler Clamp – 2"	-----2
5.	GEX7046	Manifold Clamp – 2 Bolt as O/E	-----1
	B528	Manifold Clamp – 1 Bolt Replacement	-----1
6.	GEX7337	Bracket – fits on Trans – Front Clip Support	-----1
7.	GEX7053	Front Clip – Pipe to Bracket	-----1
8.	GEX7081	Centre Mount – Rubber	-----1
9.	GEX7082	Twist Bracket – Mount to Clip	-----1
10.	GEX7052	Centre Clip – Front Pipe Support	-----1
11.	GEX7251	Rear Mount – Bobbin Style – Rubber	-----1
12.	GEX7084	Rear Clip – Tail Pipe Support	-----1
12k.	MM015	Exhaust Assembly Kit – Includes 1 to 12	-----1
	GEX107	Exhaust System – Van & Wagon – 1Pce. System	-----1
	MM337	1 Pce. Exhaust System - Includes 1 to 3	-----1
14.	GEX117	Exhaust Assembly – Cooper ‘S’ - From Header Back	-----1
14.	MM325	Exhaust Assembly – RC40 – ‘S’ Replacement	-----1
15.	MM436	Intermediate Pipe ‘S’	-----1
16.	GEX7248	Centre Clip – Front Pipe Support – Cooper ‘S’	-----1
17.	GEX7081	Centre Mount – Rubber	-----1
18.	UPC4	Muffler Clamp – 1 1/2"	-----2
19.	GEX7429	Rear Bracket – Tail Pipe Support – Cooper ‘S’	-----1
20.	GEX7251	Rear Mount – Bobbin Style – Rubber	-----1



20

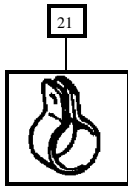

21

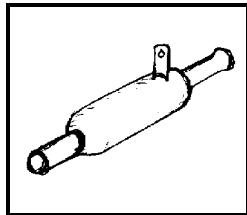

22

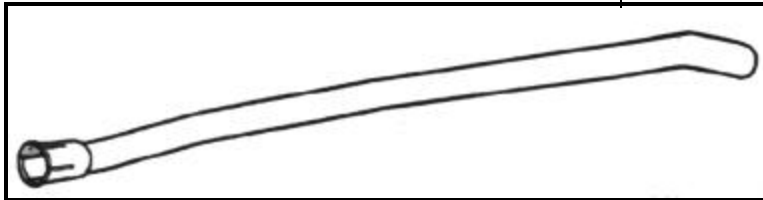

27



29

EXHAUST SYSTEM CONT'D

Qty. Req'd.

20.	MM334	Exhaust Header – LCB – 1 5/8" -----	1
20.	MM335	Exhaust Header – LCB – 3 into 1 – 1 3/8" Dia. -----	1
21.	MM898	Exhaust Header Clamp – 1 1/2" -----	1
21.	MM899	Exhaust Header Clamp – 1 3/4" -----	1
22.	MM330	Sport Muffler – 998cc – 1 1/4" Inlet – Blue -----	1
22.	MM331	Sport Muffler – 1 1/2" Inlet -----	1
22.	MM333	Sport Muffler – 1 3/4" Inlet – Red -----	1
27.	MM346	Centre Pipe -----	1
29.	MM372	Sport Muffler – Twin Pipe – Sportex -----	1
29.	MM933	Sport Muffler – Peco – Big Bore – Twin Pipe -----	1
29.	MM373	Sport Muffler – Twin Pipe muffler -----	1
29.	MM1245	Slash Cut Oval – stainless/chrome muffler -----	1
29.	MM1246	Mega Round – stainless/chrome muffler -----	1
29.	MM1247	Stainless Bosal – single outlet muffler -----	1
29.	MM1248	Stainless Bosal – single upsweep muffler -----	1
29.	MM1249	Stainless Bosal – twin outlet muffler -----	1
29.	MM1250	Stainless Muffler – large twin outlet muffler -----	1